

207 208  
227 228

208 209  
228 229

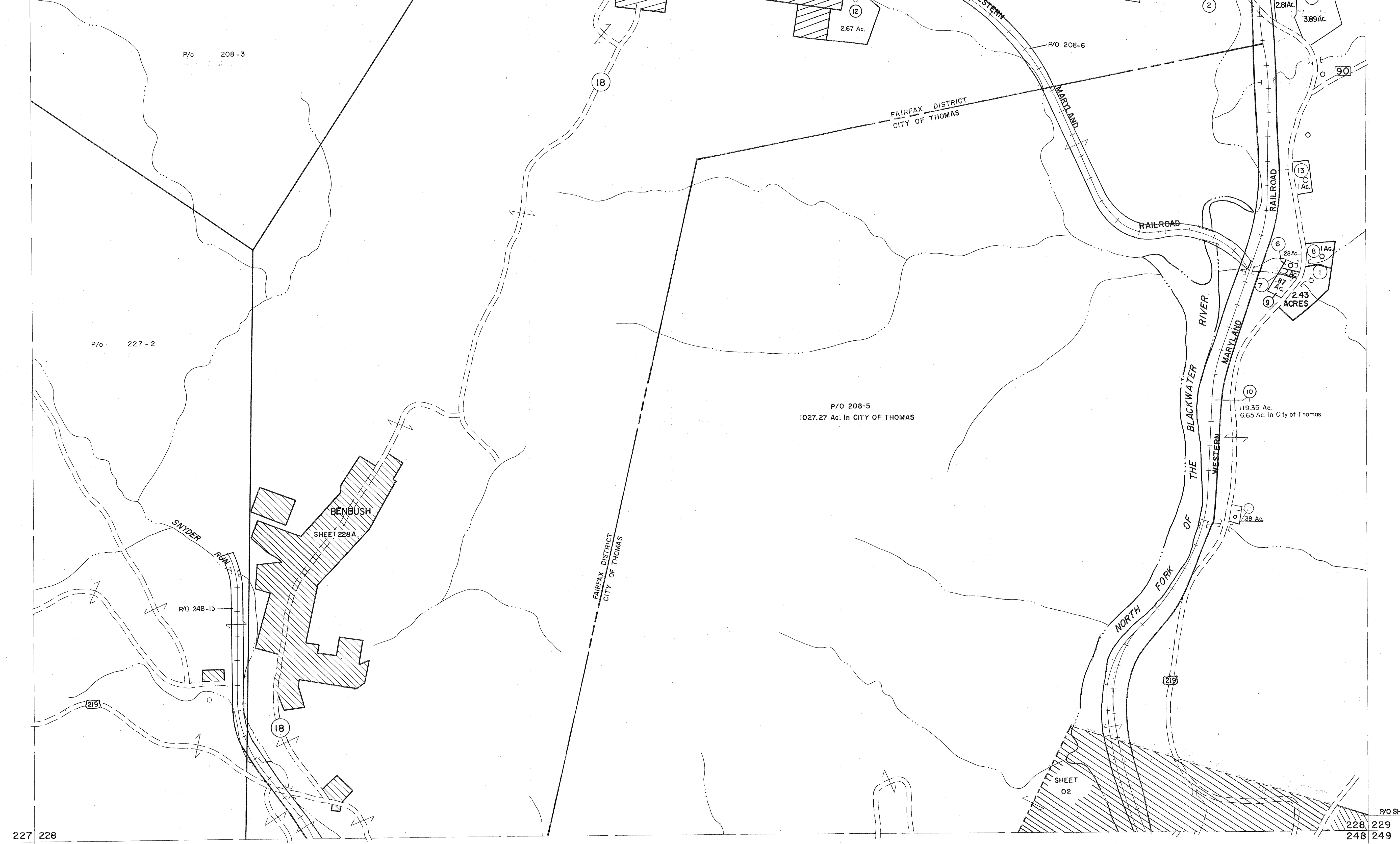

227 228  
247 248

228 229  
248 249

**For Tax Purposes Only**

Prepared by  
**MICHAEL BAKER, JR., INC.**  
Consulting Engineers  
Rochester, Pennsylvania

**Legend**

Property line	—	Original lot line	—
Edge of pavement or roadway	—	Deed lot number	(15)
Corporation line	—	Parcel or index number	(99)
District line	—	Improvement	○
County line	—	Railroad	—

**Revisions**

1	6-3-64	9	SLS INC. - DDC 7/97	17	6-21-09	H&S
2	JUNE 75 PAM	10	SLS INC. 1/27/99 DSW	18		
3	11-21-78 DG	11	SLS INC. 3/1/00 JWM	19		
4	1/21/82	12	ESI 1/31/01 REK	20		
5	REV TO 3-1-89	13	ESI 2/7/02 REK	21		
6	OGIS 12/31/90 DSH	14	H&S 2/22/04	22		
7	OGIS 3-19-92 TL	15	3/21/05 S&H	23		
8	O.G.I.S. 4-1-96 J.E.B	16	6-22-08 H&S	24		

**KEY MAP**

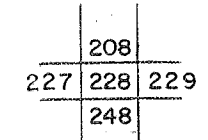

**TUCKER COUNTY**  
STATE OF WEST VIRGINIA  
Office of Assessor

**DISTRICT**

**FAIRFAX**

**SHEET NO: 228**

Date, Aerial Photography: November, 1961 Date, Map: Dec. 1962  
Photo No: Scale: 1" = 400'