

FOR TAX PURPOSES ONLY

Prepared By:  
**Max Cochran**  
 Webster County Assessor

**Legend**

Property Line	—	Original Lot Line	- - - - -
Road Right of Way	—	Lot Number	(15)
Corporation Line	—	Parcel Number	(99)
District Line	—	Water	—
County Line	—	Railroad	—

R	1	Revised 04/01/2018	9		17
O	2	Revised 01/31/2019	10		18
V	3		11		19
I	4		12		20
S	5		13		21
I	6		14		22
O	7		15		23
N	8		16		24

**STATE OF WEST VIRGINIA**  
**COUNTY OF WEBSTER**  
 Office of Assessor

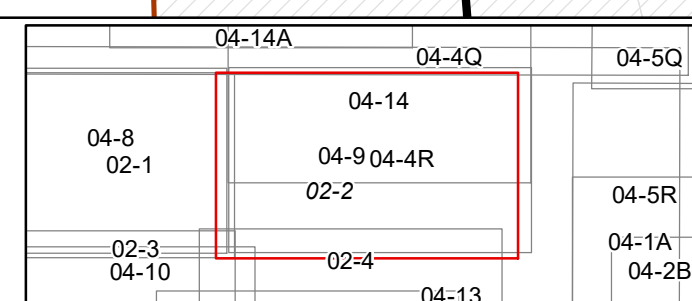

**COWEN**  
 Map: 2  
 Date, Aerial Photography: 2003  
 Date, Map: 1/31/2019  
 Scale: 1" = 100'