

FOR TAX PURPOSES ONLY

Prepared By:

Max Cochran
Webster County Assessor

Legend	
Property Line	Original Lot Line
Road Right of Way	Lot Number (15)
Corporation Line	Parcel Number (99)
District Line	Water
County Line	Railroad

R	11	Revised 04/01/2018	9		17	
e	2	Revised 01/31/2019	10		18	
v	3		11		19	
i	4		12		20	
s	5		13		21	
j	6		14		22	
o	7		15		23	
n	8		16		24	

STATE OF WEST VIRGINIA
COUNTY OF WEBSTER
Office of Assessor

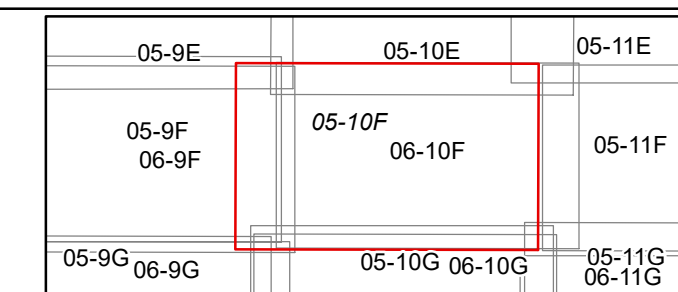

HACKER VALLEY
Map: 10F

Date, Aerial Photography: 2003

Date, Map: 1/31/2019

Scale: 1" = 400'