

FOR TAX PURPOSES ONLY
LANDMARK
 geospatial
A Division of Landmark Forestry LLC

Legend	
	District Boundary
	Previous Deed
	Property
	Road Easement
	Railroad Right of Way
	Road Right of Way
	River
	Deed Lot Number (15)
	Parcel or Index Number
	Unknown
	Improvement
	Cemetery
	Church
	Educational

Restriction
 REPRODUCTION OF TAX MAPS PROHIBITED
 - It is unlawful to copy, photocopy, scan, photograph, or otherwise reproduce this tax map. Pursuant to the provisions of W.Va. CSR § 189-5-5 (2013) no person may reproduce, copy, distribute or sell copies of tax maps prepared by the counties without having first obtained the written permission of the Barbour County Assessor. In addition to other penalties and civil remedies, any person who, without the written permission of the Barbour County Assessor, reproduces, copies, distributes, or sells or who allows the reproduction, copying, distribution or sale of tax maps prepared by the Barbour County Assessor, shall be refused permission by the Barbour County Assessor or Assessor's agent to purchase tax maps in the future.

Revisions			
1	10	19	28
2	11	20	29
3	12	21	30
4	13	22	31
5	14	23	32
6	15	24	33
7	16	25	34
8	17	26	35
9	18	27	36

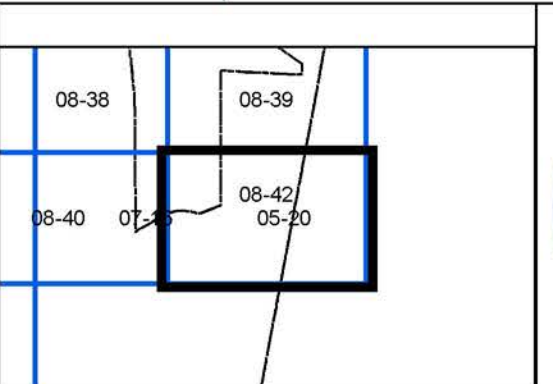

BARBOUR COUNTY
 Assessor's Office
 John M Cutright, Assessor
 PHILIPPI, WV

PHILIPPI CORP
 District 08 Map No. 42
 Date of Publication: 1/30/2017
 Scale: 1"=100'