

MOORE & OHIO RAILROAD
 OPEQUON DISTRICT
 ARDEN DISTRICT

(VAN CLEVES SUBD)

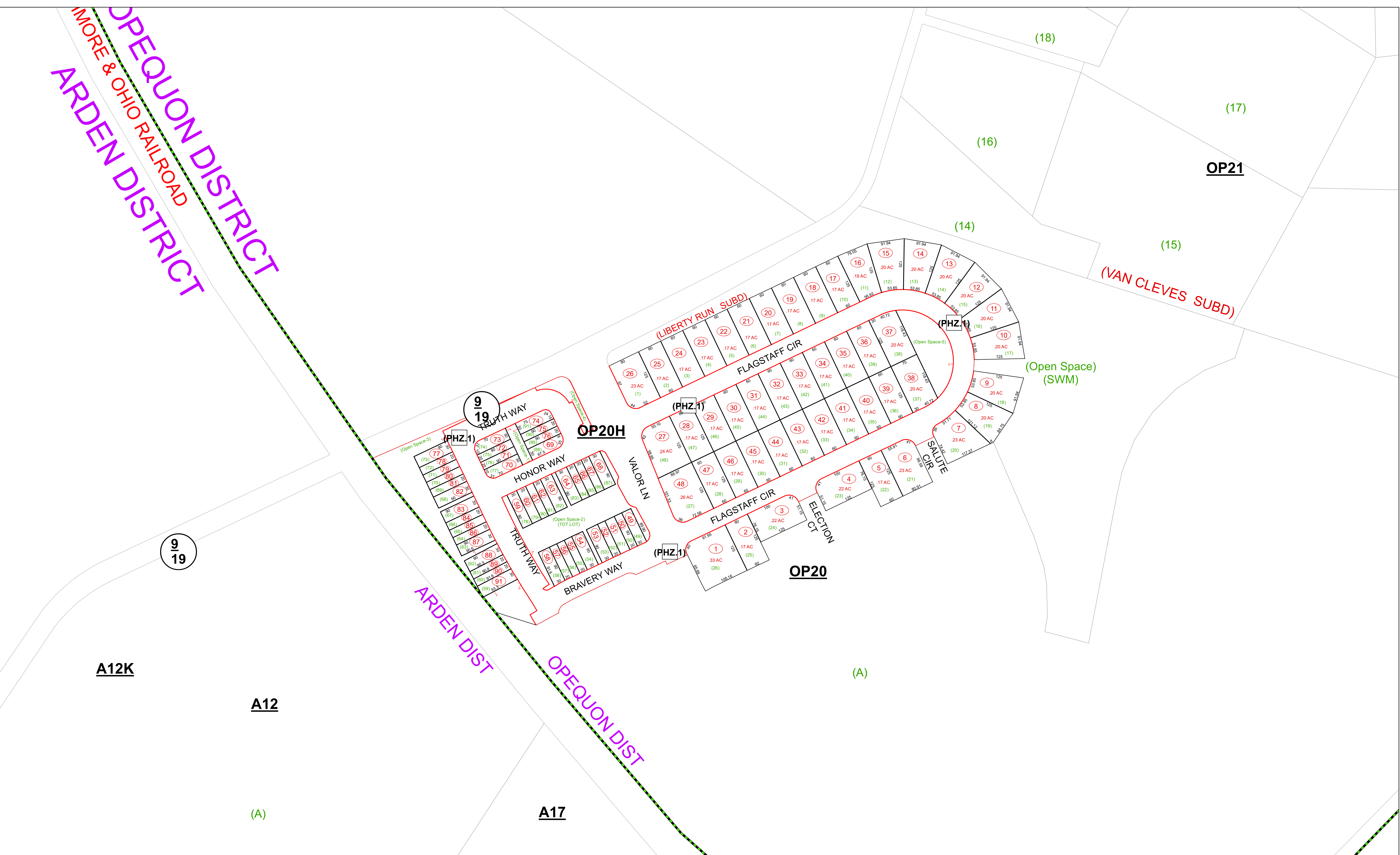

A12K

A12

A17

LEGEND

- (15) Lot Number
- 123 Parcel Number
- 72 Block Number
- 45/7 State Road Number
- Property Line
- Right-of-Way
- Original Property Line
- Easement
- District Line
- County Line
- Hydro
- Corporation Line

REVISION

1	Current to 01/20/2022
---	-----------------------

Print Date: 1/20/2022

DISCLAIMER

This product was developed for taxation purposes and is therefore not suitable for legal, engineering or surveying purposes. Users of this information should review or consult the primary data and information sources to ascertain the appropriate usage of the information. Tax maps and digital parcel files (GIS files) are not to be included as activities within the practice of surveying in accordance with the "Inclusions and Exclusions of Surveying Practice" cited in W.Va. Code 30-13A-10.

RESTRICTION

All tax maps created under the provisions of reappraisal legislation are the property of the Berkeley County Assessor and the reproduction, copying, distribution or sale of such tax maps or any copies thereof without written permission of the Berkeley County Assessor is prohibited by law.

KEY MAP

OP18	OP18S	OP19
OP20	OP20H	OP21
OP20	OP20	OP21

COUNTY OF BERKELEY

STATE OF WEST VIRGINIA

Office of Assessor

For Tax Purposes Only

OP20H

Date, Aerial Photography: _____ Map Tax Year: 2022
 Photo No: _____ Scale: 1" = 100'

