

THIS AREA ASSESSED IN CLAY CO

BRAXTON COUNTY
CLAY COUNTY

WALNUT FRK

SEARS RD

WALKER FORK

1
117.1 Ac.

16

16

1.1
4 Ac.

3
43.6 Ac.

4
48.25 Ac.

5
48.25 Ac.

6
87.96 Ac.

FOR TAX PURPOSES ONLY
Prepared By:
Edith G Tichner
Braxton County Assessor

Legend

Property Line	Original Lot Line	(15)
Road Right of Way	Lot Number	(99)
Corporation Line	Parcel Number	
District Line	Water	
County Line	Railroad	

	9	17	
R	1 Revised 09/2/2020	9	17
e	2 Revised 01/27/2022	10	18
v		11	19
i		12	20
s		13	21
j		14	22
o		15	23
n		16	24
s			

STATE OF WEST VIRGINIA
COUNTY OF BRAXTON
Office of Assessor

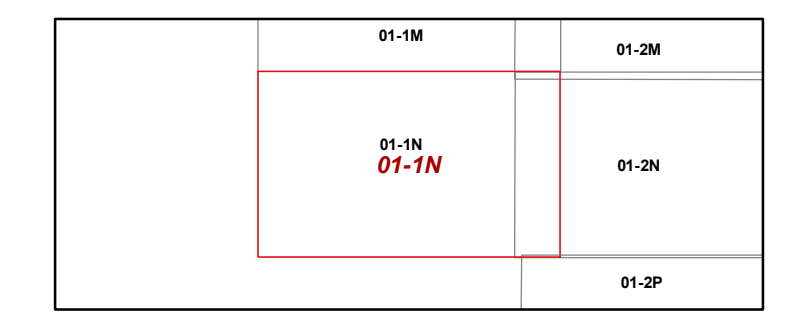

BIRCH DISTRICT
Map: 1N
Date, Aerial Photography: 2019
Date, Map: 1/27/2022
Scale: 1" = 8,708'