

7

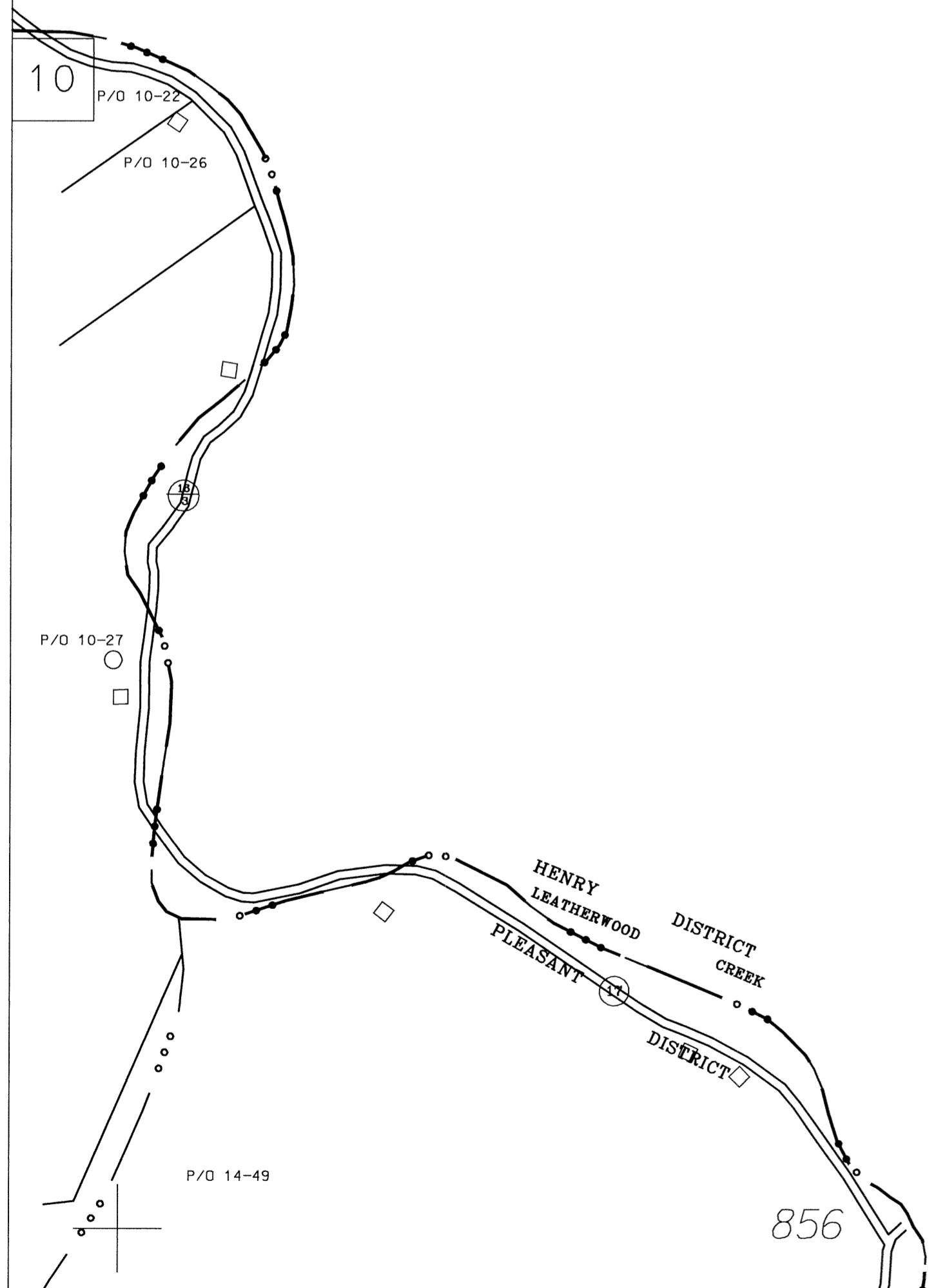

15

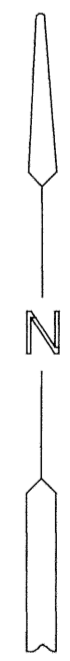

For Tax Purposes Only

Prepared by
 McKenzie Engineering Corporation
 806 Broad Street
 Summersville, WV 26651

LEGEND

Property line	---	Original lot line	---
Edge of pavement or roadway	---	Deed lot number	(15)
Corporation line	---	Parcel or index number	Ⓢ
District line	---	Improvement	o
County line	---	Railroad	+

REVISIONS

1	
2	
3	
4	
5	
6	
7	
8	

RESTRICTION

All tax maps created under the provisions of reappraisal legislation are the property of Clay County West Virginia and the reproduction, copying, distribution or sale of such tax maps or any copies thereof without the written permission of the Clay County Assessor is prohibited by law.

KEY MAP

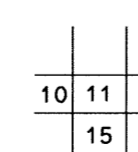

CLAY COUNTY

STATE OF WEST VIRGINIA

Office of Assessor

PLEASANT DISTRICT

SHEET NO:11

Date, Aerial Photography: 4-6-63
 Photo No: 17-1844, 1845

Date, Map: 6-8-65
 Scale: 1" = 400'

C:\pvt\c\p\map\p\map\district11.dwg 11, 2001 12:37:06