

FOR TAX PURPOSES ONLY

Prepared By:  
**Ralph Layton**  
 Grant County Assessor

**Legend**

Property Line	—	Original Lot Line	—
Road Right of Way	—	Lot Number	(15)
Corporation Line	—	Parcel Number	(99)
District Line	—	Water	—
County Line	—	Railroad	—

R	11	Revised 10/1/16	9	17
e	28	Revised 01/28/2023	11	18
v	23		12	19
i	14		13	20
s	5		14	21
i	16		15	22
o	7		16	23
n	8		17	24

**STATE OF WEST VIRGINIA**  
**COUNTY OF GRANT**  
 Office of Assessor

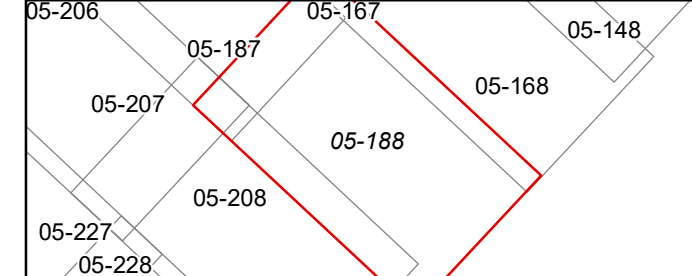

UNION  
 Map: 188  
 Date, Aerial Photography: 2015  
 Date, Map: 1/28/2022  
 Scale: 1" = 400'