

FOR TAX PURPOSES ONLY

Prepared By:  
**Ralph Layton**  
 Grant County Assessor

**Legend**

Property Line	—	Original Lot Line	- - - - -
Road Right of Way	—	Lot Number	(15)
Corporation Line	—	Parcel Number	(99)
District Line	—	Water	—
County Line	—	Railroad	—

R	11	Revised 10/1/16	9	17
e	28	Revised 01/28/2023	11	18
v	11		12	19
i	12		13	20
s	13		14	21
i	14		15	22
n	15		16	23
s	16			24

**STATE OF WEST VIRGINIA**  
**COUNTY OF GRANT**  
 Office of Assessor

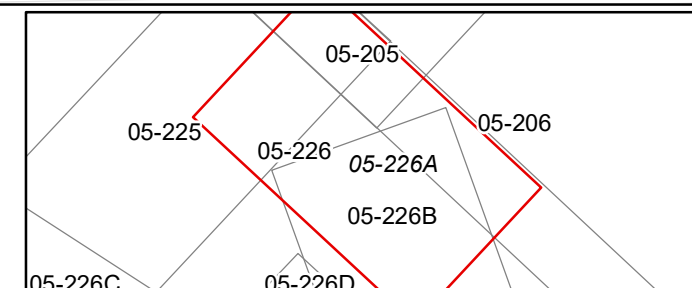

UNION  
 Map: 226A  
 Date, Aerial Photography: 2015  
 Date, Map: 1/28/2022  
 Scale: 1" = 100'