

2-587-1.2  
 2-391-1  
 LOST RIVER DISTRICT  
 VIRGINIA  
 HARDY COUNTY  
 SHENANDOAH COUNTY

FOR TAX PURPOSES ONLY  
 Prepared by Hardy County, WV

**Legend**

Property Line	—	Original Lot Line	- - - - -
Road Right of Way	—	Lot Number	(15)
Corporation Line	—	Parcel Number	(99)
District Line	—	Water	—
County Line	—	Railroad	—

R	1	Revised 7/8/2014	9	17
O	2		10	18
V	3		11	19
J	4		12	20
S	5		13	21
I	6		14	22
O	7		15	23
N	8		16	24

STATE OF WEST VIRGINIA  
 COUNTY OF HARDY  
 Office of Assessor

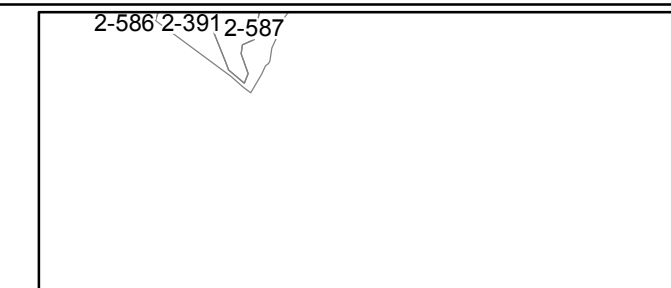

LOST RIVER  
 SHEET 607  
 Date, Aerial Photography: 2003  
 Date, Map: 1/19/2022  
 Scale: 1" = 400'