

FOR TAX PURPOSES ONLY
Prepared by Hardy County, WV

Legend

Property Line	—	Original Lot Line	- - - - -
Road Right of Way	—	Lot Number	(15)
Corporation Line	—	Parcel Number	(99)
District Line	—	Water	- - - - -
County Line	—	Railroad	—+—+—+—

R	1	Revised 7/8/2014	9		17
O	2		10		18
V	3		11		19
I	4		12		20
S	5		13		21
J	6		14		22
O	7		15		23
N	8		16		24

STATE OF WEST VIRGINIA
COUNTY OF HARDY
Office of Assessor

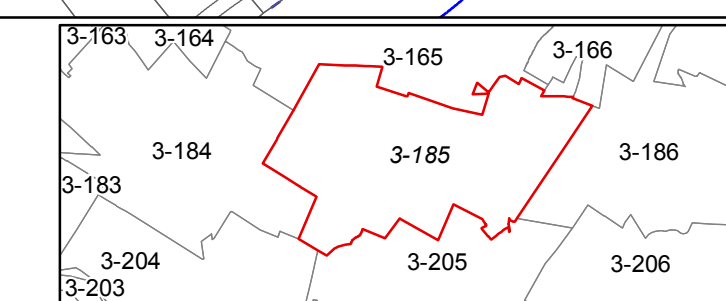

MOOREFIELD
SHEET 185
Date, Aerial Photography: 2003
Date, Map: 1/19/2022
Scale: 1" = 400'