



FOR TAX PURPOSES ONLY  
Prepared by Hardy County, WV

**Legend**

Property Line	Original Lot Line	Water
Road Right of Way	Lot Number (15)	Railroad
Corporation Line	Parcel Number (99)	
District Line		
County Line		

R	11	Revised 7/8/2014	9	17
O	2		10	18
V	3		11	19
I	4		12	20
S	5		13	21
I	6		14	22
O	7		15	23
N	8		16	24

**STATE OF WEST VIRGINIA**  
**COUNTY OF HARDY**  
Office of Assessor

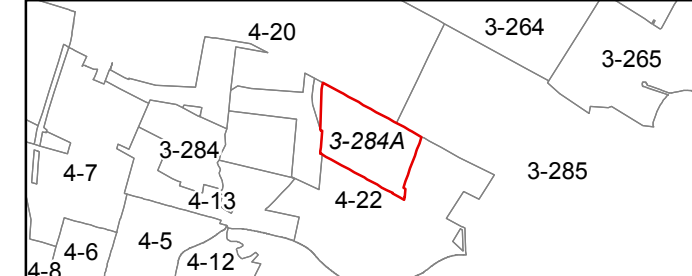

**MOOREFIELD SHEET 284A**  
Date, Aerial Photography: 2003  
Date, Map: 1/19/2022  
Scale: 1" = 150'