

FOR TAX PURPOSES ONLY
LANDMARK
 geospatial
A Division of Landmark Property LLC

Legend		
	District Boundary	
	Previous Deed	
	Property	
	Road Easement	
	Railroad Right of Way	
	Road Right of Way	
	River	
	Deed lot Number (15)	
	Parcel or Index Number	
	Unknown	
	Improvement	
	Cemetery	
	Church	
	Educational	

Restriction
 REPRODUCTION OF TAX MAPS PROHIBITED
 - It is unlawful to copy, photocopy, scan, photograph, or otherwise reproduce this tax map. Pursuant to the provisions of W.Va. CSR § 189-5-5 (2013) no person may reproduce, copy, distribute or sell copies of tax maps prepared by the counties without having first obtained the written permission of the Lewis County Assessor. In addition to other penalties and civil remedies, any person who, without the written permission of the Lewis County Assessor, reproduces, copies, distributes, or sells or who allows the reproduction, copying, distribution or sale of tax maps prepared by the Lewis County Assessor, shall be refused permission by the Lewis County Assessor or Assessor's agent to purchase tax maps in the future.

Revisions			
1	10	19	28
2	11	20	29
3	12	21	30
4	13	22	31
5	14	23	32
6	15	24	33
7	16	25	34
8	17	26	35
9	18	27	36

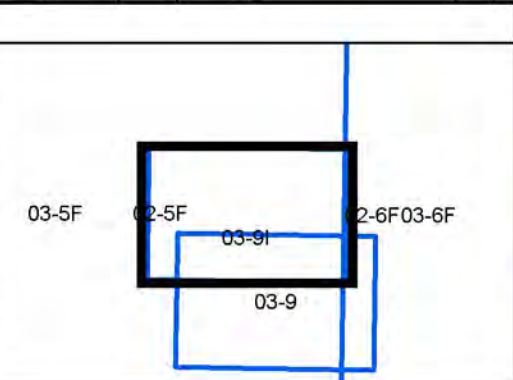

LEWIS COUNTY
 Assessor's Office
T. Chad Kelley, Assessor
 WESTON, WV

FREEMANS CREEK
 District 03 Map No. 9I
 Date of Publication: 10/21/2014
 Scale: 1" = 100'