

FOR TAX PURPOSES ONLY

Prepared By:
Glen D. "Houn' Dog" Adkins
 Logan County, WV Tax Assessor
 All finished tax maps created by provision of West Virginia law and are the property of the county assessors who created them. The reproduction, copying, distribution, sale or lease of such maps or copies thereof without the written permission of the respective county assessor is prohibited by law.

Legend	
Property Line	Original Lot Line
Road Right of Way	Lot Number
Corporation Line	Parcel Number
District Line	County Line
Easement	Railroad
	(15)
	(99)

Coordinate System: NAD 1983 StatePlane West Virginia South FIPS 4702 Feet
 Projection: Lambert Conformal Conic
 Datum: North American 1983
 False Easting: 1,968,500.0000
 False Northing: 0.0000
 Central Meridian: -81.0000
 Standard Parallel 1: 37.4833
 Standard Parallel 2: 38.8833
 Latitude Of Origin: 37.0000
 Units: Foot US

STATE OF WEST VIRGINIA
COUNTY OF LOGAN
 Office of Assessor

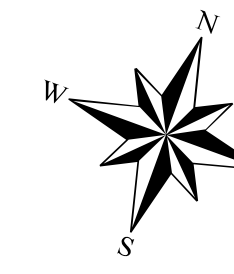
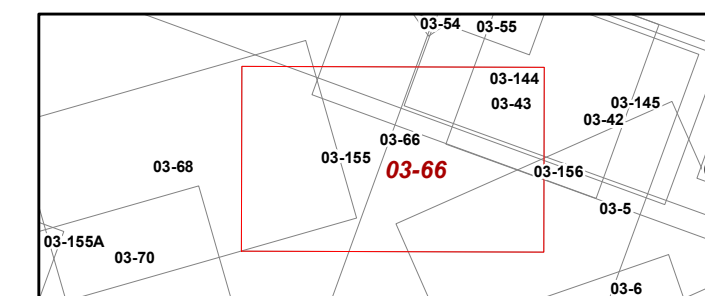

Island Creek Dist
 Map: 66
 Date, Aerial Photography: 2018
 Date, Map: 11/19/2021
 Scale: 1" = 100'
 Date Last Revised: 5/4/2021