



FOR TAX PURPOSES ONLY

Prepared By:  
**Glen D. "Houn' Dog" Adkins**  
 Logan County, WV Tax Assessor

All finished tax maps created by provision of West Virginia law and are the property of the county assessors who created them. The reproduction, copying, distribution, sale or lease of such maps or copies thereof without the written permission of the respective county assessor is prohibited by law

**Legend**

Property Line	Original Lot Line	(15)
Road Right of Way	Lot Number	(99)
Corporation Line	Parcel Number	
District Line	Water	
County Line	Railroad	
Easement		

Coordinate System: NAD 1983 StatePlane West Virginia South FIPS 4702 Feet  
 Projection: Lambert Conformal Conic  
 Datum: North American 1983  
 False Easting: 1,968,500.0000  
 False Northing: 0.0000  
 Central Meridian: -81.0000  
 Standard Parallel 1: 37.4833  
 Standard Parallel 2: 38.8833  
 Latitude Of Origin: 37.0000  
 Units: Foot US

**STATE OF WEST VIRGINIA**  
**COUNTY OF LOGAN**  
 Office of Assessor

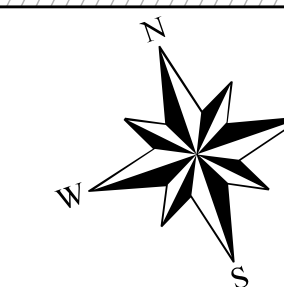
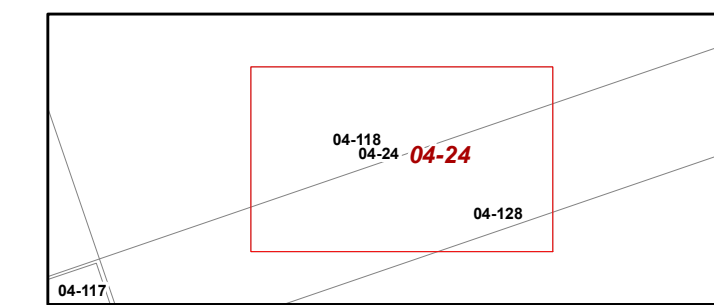

Logan Rural Dist  
 Map: 24  
 Date, Aerial Photography: 2018  
 Date, Map: 11/19/2021  
 Scale: 1" = 100'  
 Date Last Revised: 5/4/2021