

**FOR TAX PURPOSES ONLY**

This tax map is a copy of the Assessor's official record and the reproduction, copying, distribution, or sale of such tax maps or any copies thereof without the written permission of the County Assessor is prohibited.

**Legend**

Property Line	—	Original Lot Line	---
Road Right of Way	—	Water	---
Railroad	—	Parcel ID Number	99
Parcel Hook	—	Deed Lot Number	(15)

R	11	December 2012	9	December 2020	17
G	2	December 2013	10	December 2021	18
V	3	December 2014	11		19
I	4	December 2015	12		20
S	5	December 2016	13		21
I	6	December 2017	14		22
O	7	December 2018	15		23
H	8	December 2019	16		24

**MINERAL COUNTY, WEST VIRGINIA**

For Tax Purposes Only  
Office of the Assessor

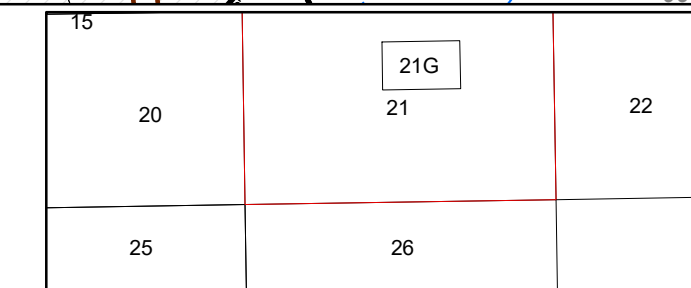

Created: 1/20/2022  
Scale: 1" = 400'

District: ELK  
Map: 21