

FOR TAX PURPOSES ONLY

Prepared By:  
**Norb Netzel**  
 Monroe County Assessor

**Legend**

|                   |   |                   |      |
|-------------------|---|-------------------|------|
| Property Line     | — | Original Lot Line | ---  |
| Road Right of Way | — | Lot Number        | (15) |
| Corporation Line  | — | Parcel Number     | (99) |
| District Line     | — | Water             | ---  |
| County Line       | — | Railroad          | ---  |

|   |   |                    |    |    |
|---|---|--------------------|----|----|
| R | 1 | Revised 3/1/15     | 9  | 17 |
| Q | 2 | Revised 3/1/16     | 10 | 18 |
| V | 3 | Revised 12/30/2016 | 11 | 19 |
| I | 4 | Revised 09/27/2017 | 12 | 20 |
| S | 5 | Revised 01/25/2018 | 13 | 21 |
| J | 6 | Revised 01/25/2019 | 14 | 22 |
| O | 7 | Revised 01/25/2020 | 15 | 23 |
| N | 8 | Revised 01/25/2022 | 16 | 24 |

**STATE OF WEST VIRGINIA**  
**COUNTY OF MONROE**  
 Office of Assessor

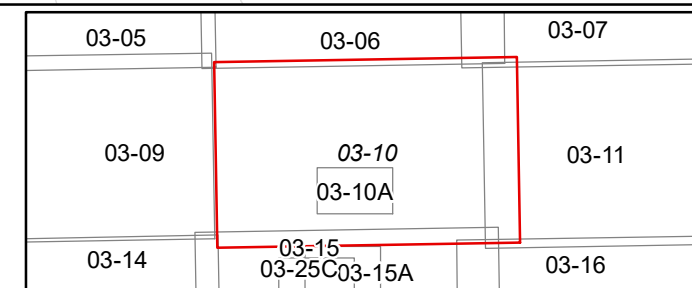

**RED SULPHUR**  
 Map: 10  
 Date, Aerial Photography: 2003  
 Date, Map: 1/26/2022  
 Scale: 1" = 400'