



FOR TAX PURPOSES ONLY

Prepared By:

Norb Netzel  
Monroe County Assessor

| Legend            |                    |
|-------------------|--------------------|
| Property Line     | Original Lot Line  |
| Road Right of Way | Lot Number (15)    |
| Corporation Line  | Parcel Number (99) |
| District Line     | Water              |
| County Line       | Railroad           |

|   |   |                    |    |    |
|---|---|--------------------|----|----|
| R | 1 | Revised 3/1/15     | 9  | 17 |
| O | 2 | Revised 3/1/16     | 10 | 18 |
| V | 3 | Revised 12/30/2016 | 11 | 19 |
| I | 4 | Revised 09/27/2017 | 12 | 20 |
| S | 5 | Revised 01/25/2018 | 13 | 21 |
| I | 6 | Revised 01/25/2019 | 14 | 22 |
| O | 7 | Revised 01/25/2020 | 15 | 23 |
| N | 8 | Revised 01/25/2022 | 16 | 24 |

STATE OF WEST VIRGINIA  
COUNTY OF MONROE  
Office of Assessor

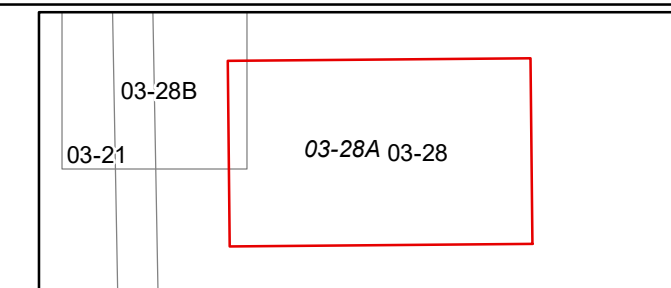

RED SULPHUR  
Map: 28A  
Date, Aerial Photography: 2003  
Date, Map: 1/26/2022  
Scale: 1" = 100'