

FOR TAX PURPOSES ONLY

Prepared By:
Sarah Martin
 Monroe County Assessor

Legend

| | | | |
|-------------------|---|--------------------|-----------|
| Property Line | — | Original Lot Line | - - - - - |
| Road Right of Way | — | Lot Number (15) | (15) |
| Corporation Line | — | Parcel Number (99) | (99) |
| District Line | — | Water | ~~~~~ |
| County Line | — | Railroad | —+—+—+— |

| | | | | |
|---|----|--------------------|----|----|
| R | 11 | Revised 3/1/15 | 9 | 17 |
| O | 2 | Revised 3/1/16 | 10 | 18 |
| V | 3 | Revised 12/30/2016 | 11 | 19 |
| I | 4 | Revised 09/27/2017 | 12 | 20 |
| S | 5 | Revised 01/25/2018 | 13 | 21 |
| J | 6 | Revised 01/25/2019 | 14 | 22 |
| O | 7 | Revised 01/25/2021 | 15 | 23 |
| N | 8 | Revised 01/25/2022 | 16 | 24 |

STATE OF WEST VIRGINIA
COUNTY OF MONROE
 Office of Assessor

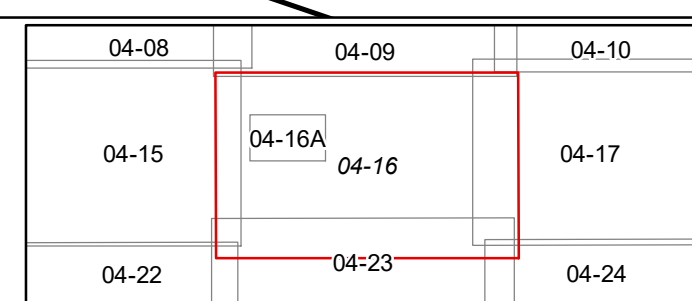

SECOND CREEK
 Map: 16
 Date, Aerial Photography: 2003
 Date, Map: 1/26/2022
 Scale: 1" = 400'