



FOR TAX PURPOSES ONLY

Prepared By:
Sarah Martin
 Monroe County Assessor

Legend

Property Line	—	Original Lot Line	- - - - -
Road Right of Way	—	Lot Number	(15)
Corporation Line	—	Parcel Number	(99)
District Line	—	Water	—
County Line	—	Railroad	—

R	1	Revised 3/1/15	9		17
O	2	Revised 3/1/16	10		18
V	3	Revised 12/30/2016	11		19
I	4	Revised 09/27/2017	12		20
S	5	Revised 01/25/2018	13		21
J	6	Revised 01/25/2019	14		22
O	7	Revised 01/25/2021	15		23
N	8	Revised 01/25/2022	16		24

STATE OF WEST VIRGINIA
COUNTY OF MONROE
 Office of Assessor

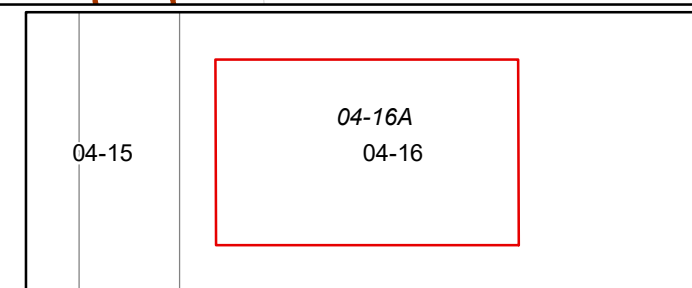

SECOND CREEK
 Map: 16A
 Date, Aerial Photography: 2003
 Date, Map: 1/26/2022
 Scale: 1" = 100'