

FOR TAX PURPOSES ONLY

Prepared By:
Sarah Martin
 Monroe County Assessor

Legend

| | |
|-------------------|--------------------|
| Property Line | Original Lot Line |
| Road Right of Way | Lot Number (15) |
| Corporation Line | Parcel Number (99) |
| District Line | Water |
| County Line | Railroad |

| | | | | | |
|---|---|--------------------|----|--------------------|----|
| R | 1 | Revised 3/1/15 | 9 | Revised 01/25/2022 | 17 |
| 0 | 2 | Revised 3/1/16 | 10 | | 18 |
| V | 3 | Revised 12/30/2016 | 11 | | 19 |
| I | 4 | Revised 09/27/2017 | 12 | | 20 |
| S | 5 | Revised 01/25/2018 | 13 | | 21 |
| I | 6 | Revised 01/25/2019 | 14 | | 22 |
| O | 7 | Revised 01/25/2020 | 15 | | 23 |
| N | 8 | Revised 01/25/2021 | 16 | | 24 |

STATE OF WEST VIRGINIA
COUNTY OF MONROE
 Office of Assessor

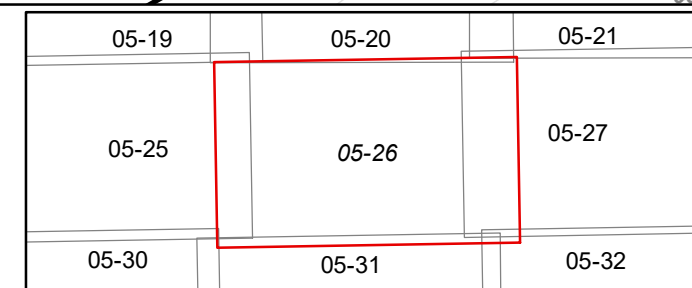

SPRINGFIELD
 Map: 26
 Date, Aerial Photography: 2003
 Date, Map: 1/25/2022
 Scale: 1" = 400'