

FOR TAX PURPOSES ONLY

Prepared By:  
**Sarah Martin**  
 Monroe County Assessor

**Legend**

Property Line	—	Original Lot Line	- - - - -
Road Right of Way	—	Lot Number	(15)
Corporation Line	—	Parcel Number	(99)
District Line	—	Water	—
County Line	—	Railroad	—

R	1	Revised 3/1/15	9	Revised 01/25/2022	17
0	2	Revised 3/1/16	10		18
V	3	Revised 12/30/2016	11		19
I	4	Revised 09/27/2017	12		20
S	5	Revised 01/25/2018	13		21
I	6	Revised 01/25/2019	14		22
0	7	Revised 01/25/2020	15		23
n	8	Revised 01/25/2021	16		24

**STATE OF WEST VIRGINIA**  
**COUNTY OF MONROE**  
 Office of Assessor

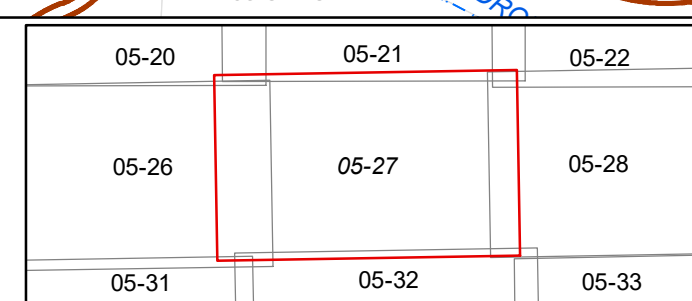

SPRINGFIELD  
 Map: 27  
 Date, Aerial Photography: 2003  
 Date, Map: 1/25/2022  
 Scale: 1" = 400'