

FOR TAX PURPOSES ONLY

Prepared By:  
**Sarah Martin**  
 Monroe County Assessor

Legend	
Property Line	Original Lot Line
Road Right of Way	Lot Number (15)
Corporation Line	Parcel Number (99)
District Line	Water
County Line	Railroad

R	1	Revised 3/1/15	9		17
O	2	Revised 3/1/16	10		18
V	3	Revised 12/30/2016	11		19
I	4	Revised 09/27/2017	12		20
S	5	Revised 01/25/2018	13		21
I	6	Revised 01/25/2019	14		22
O	7	Revised 01/25/2020	15		23
N	8	Revised 01/25/2021	16		24

**STATE OF WEST VIRGINIA**  
**COUNTY OF MONROE**  
 Office of Assessor

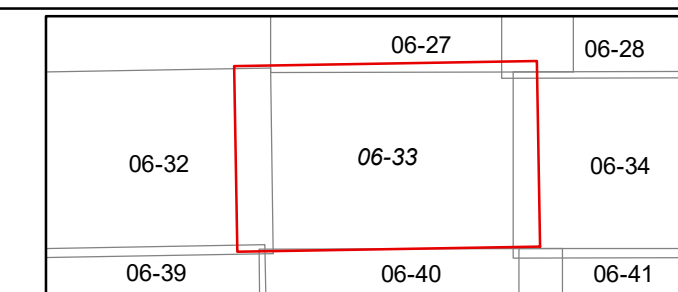

**SWEET SPRINGS**  
 Map: 33  
 Date, Aerial Photography: 2003  
 Date, Map: 1/25/2022  
 Scale: 1" = 400'