

FOR TAX PURPOSES ONLY

Prepared By:
Sarah Martin
 Monroe County Assessor

Legend

Property Line	—	Original Lot Line	---
Road Right of Way	—	Lot Number	(15)
Corporation Line	—	Parcel Number	(99)
District Line	- - - -	Water	~~~~~
County Line	- - - -	Railroad	—+—+—

R	1	Revised 3/1/15	9	17
O	2	Revised 3/1/16	10	18
V	3	Revised 12/30/16	11	19
I	4	Revised 09/27/2017	12	20
S	5	Revised 01/25/2018	13	21
J	6	Revised 01/25/2019	14	22
O	7	Revised 01/25/2020	15	23
N	8	Revised 01/25/2022	16	24

STATE OF WEST VIRGINIA
COUNTY OF MONROE
 Office of Assessor

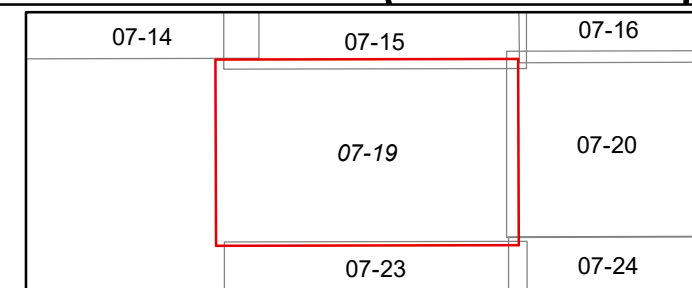

UNION
 Map: 19
 Date, Aerial Photography: 2003
 Date, Map: 1/25/2022
 Scale: 1" = 400'