

FOR TAX PURPOSES ONLY
 Prepared By:
Debbie Weaver
 Morgan County Assessor

Legend

	District Boundary		Deed lot Number	(15)
	Previous Deed		Parcel or Index Number	(9)
	Property		Unknown	(4)
	Road Easement		Improvement	(1)
	Railroad Right of Way		Cemetery	(1)
	Road Right of Way		Church	(1)
	River		Educational	(1)

Restriction

REPRODUCTION OF TAX MAPS PROHIBITED
 - It is unlawful to copy, photocopy, scan, photograph, or otherwise reproduce this tax map. Pursuant to the provisions of W.Va. CSR § 189-5-5 (2013) no person may reproduce, copy, distribute or sell copies of tax maps prepared by the counties without having first obtained the written permission of the Morgan County Assessor. In addition to other penalties and civil remedies, any person who, without the written permission of the Morgan County Assessor, reproduces, copies, distributes, or sells or who allows the reproduction, copying, distribution or sale of tax maps prepared by the Morgan County Assessor, shall be refused permission by the Morgan County Assessor or Assessor's agent to purchase tax maps in the future.

Revisions

1	Revised 12/30/2016	10	19	28
2	Revised 02/8/2019	11	20	29
3	Revised 01/20/2020	12	21	30
4	Revised 11/20/2020	13	22	31
5	Revised 11/20/2022	14	23	32
6		15	24	33
7		16	25	34
8		17	26	35
9		18	27	36

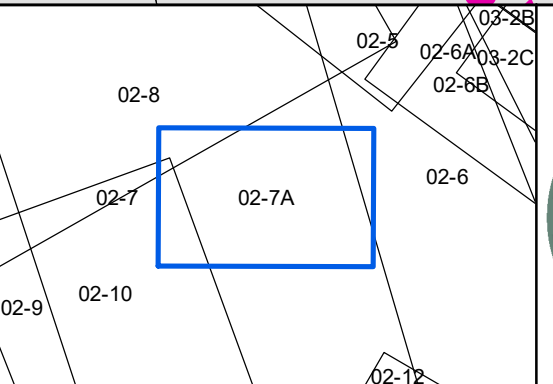

MORGAN COUNTY
 Assessor's Office
 Debbie Weaver, Assessor
 Berkeley Springs, WV

BATH
 District: 02 Map No: 7A
 Date of Publication: 1/25/2022
 Scale: 1" = 200'