

FOR TAX PURPOSES ONLY

Prepared By:
Debbie Weaver
 Morgan County Assessor

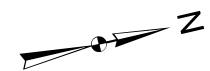

Legend

	District Boundary		Deed lot Number
	Previous Deed		Parcel or Index Number
	Property		Unknown
	Road Easement		Improvement
	Railroad Right of Way		Cemetery
	Road Right of Way		Church
	River		Educational

Restriction

REPRODUCTION OF TAX MAPS PROHIBITED
 - It is unlawful to copy, photocopy, scan, photograph, or otherwise reproduce this tax map. Pursuant to the provisions of W.Va. CSR § 189-5-5 (2013) no person may reproduce, copy, distribute or sell copies of tax maps prepared by the counties without having first obtained the written permission of the Morgan County Assessor. In addition to other penalties and civil remedies, any person who, without the written permission of the Morgan County Assessor, reproduces, copies, distributes, or sells or who allows the reproduction, copying, distribution or sale of tax maps prepared by the Morgan County Assessor, shall be refused permission by the Morgan County Assessor or Assessor's agent to purchase tax maps in the future.

Revisions

1	Revised 12/30/2016	10	19	28
2	Revised 02/8/2019	11	20	29
3	Revised 01/20/2020	12	21	30
4	Revised 11/20/2020	13	22	31
5		14	23	32
6		15	24	33
7		16	25	34
8		17	26	35
9		18	27	36

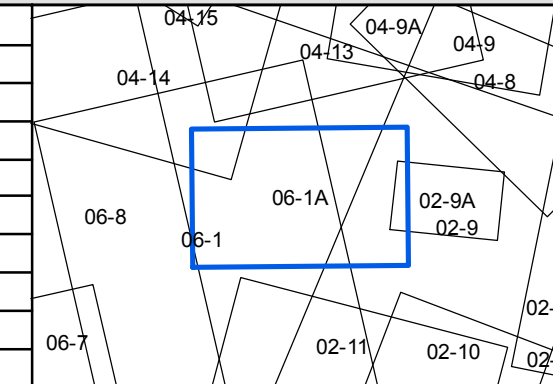

MORGAN COUNTY

Assessor's Office
Debbie Weaver, Assessor
 Berkeley Springs, WV

ROCK GAP

District: 06 Map No: 1A
 Date of Publication: 2/1/2021
 Scale: 1" = 200'