

FOR TAX PURPOSES ONLY

LANDMARK geospatial  
A Division of Landmark Forestry LLC

**Legend**

--- District Boundary	Deed lot Number (15)
- - - Previous Deed	Parcel or Index Number (9)
— Property	Unknown
- - - Road Easement	Improvement (0)
— Railroad Right of Way	Cemetery (†)
— Road Right of Way	Church (†)
— River	Educational (†)

**Restriction**

REPRODUCTION OF TAX MAPS PROHIBITED  
- It is unlawful to copy, photocopy, scan, photograph, or otherwise reproduce this tax map. Pursuant to the provisions of W. Va. CSR § 189-5-5 (2013) no person may reproduce, copy, distribute or sell copies of tax maps prepared by the counties without having first obtained the written permission of the Nicholas County Assessor. In addition to other penalties and civil remedies, any person who, without the written permission of the Nicholas County Assessor, reproduces, copies, distributes, or sells or who allows the reproduction, copying, distribution or sale of tax maps prepared by the Nicholas County Assessor, shall be refused permission by the Nicholas County Assessor or Assessor's agent to purchase tax maps in the future.

1	LANDMARK	5/2014	10	19	28
2			11	20	29
3			12	21	30
4			13	22	31
5			14	23	32
6			15	24	33
7			16	25	34
8			17	26	35
9			18	27	36

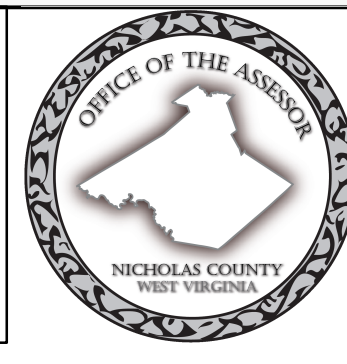
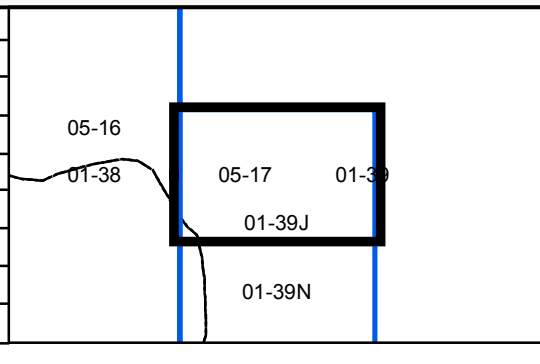

**NICHOLAS COUNTY** **BEAVER**

Assessor's Office

SUMMERSVILLE, WV

District 01 Map No. 39J

Date of Publication: 1/26/2022

Scale: 1"=100'