

FOR TAX PURPOSES ONLY  
 Prepared By:  
**Tiffany Hoffman**  
 Ohio County Assessor

**Legend**

|                   |                    |
|-------------------|--------------------|
| Property Line     | Original Lot Line  |
| Road Right of Way | Lot Number (15)    |
| Corporation Line  | Parcel Number (99) |
| District Line     | Water              |
| County Line       | Railroad           |

|   |   |                    |    |    |
|---|---|--------------------|----|----|
| R | 1 | Revised 9/3/2019   | 9  | 17 |
| O | 2 | Revised 01/28/2020 | 10 | 18 |
| V | 3 | Revised 01/28/2021 | 11 | 19 |
| I | 4 | Revised 01/28/2021 | 12 | 20 |
| S | 5 | Revised 01/28/2022 | 13 | 21 |
| I | 6 |                    | 14 | 22 |
| O | 7 |                    | 15 | 23 |
| n | 8 |                    | 16 | 24 |

**STATE OF WEST VIRGINIA**  
**COUNTY OF OHIO**  
 Office of Assessor

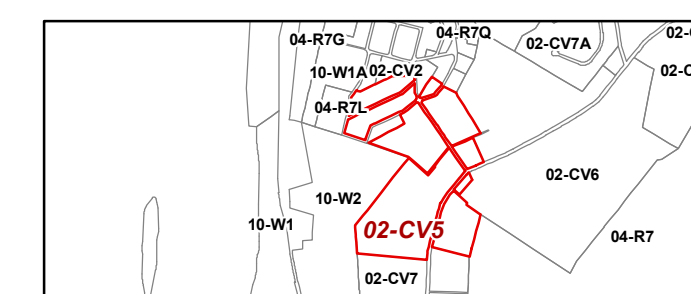

Clearview  
 Map: CV5  
 Date, Aerial Photography: 2015  
 Date, Map: 1/28/2022  
 Scale: 1" = 100'