

FOR TAX PURPOSES ONLY

Prepared By:  
**Tiffany Hoffman**  
 Ohio County Assessor

Legend	
Property Line	Original Lot Line
Road Right of Way	Lot Number (15)
Corporation Line	Parcel Number (99)
District Line	Water
County Line	Railroad

R	1	Revised 9/3/2019	9	17
O	2	Revised 01/28/2020	11	18
V	3	Revised 01/28/2021	12	19
I	4		13	20
S	5		14	21
I	6		15	22
O	7		16	23
N	8			24

**STATE OF WEST VIRGINIA**  
**COUNTY OF OHIO**  
 Office of Assessor

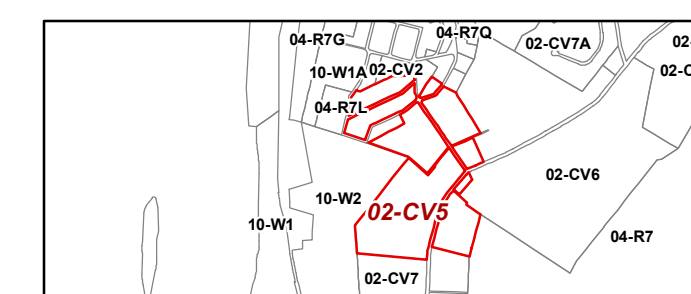

Clearview  
 Map: CV5

Date, Aerial Photography: 2015  
 Date, Map: 2/22/2021  
 Scale: 1" = 100'