

FOR TAX PURPOSES ONLY
 Prepared By:
Tiffany Hoffman
 Ohio County Assessor

| Legend | |
|-------------------|--------------------|
| Property Line | Original Lot Line |
| Road Right of Way | Lot Number (15) |
| Corporation Line | Parcel Number (99) |
| District Line | Water |
| County Line | Railroad |

| | | | | | |
|---|---|--------------------|----|--|----|
| R | 1 | Revised 9/3/2019 | 9 | | 17 |
| O | 2 | Revised 01/28/2020 | 10 | | 18 |
| V | 3 | Revised 01/28/2021 | 11 | | 19 |
| I | 4 | Revised 01/28/2022 | 12 | | 20 |
| S | 5 | | 13 | | 21 |
| I | 6 | | 14 | | 22 |
| O | 7 | | 15 | | 23 |
| N | 8 | | 16 | | 24 |

STATE OF WEST VIRGINIA
COUNTY OF OHIO
 Office of Assessor

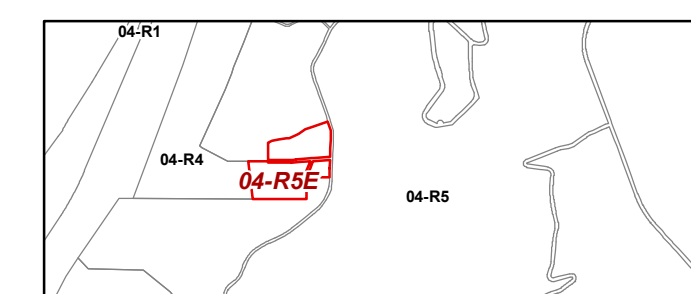

Richland
 Map: R5E
 Date, Aerial Photography: 2015
 Date, Map: 1/28/2022
 Scale: 1" = 100'