

FOR TAX PURPOSES ONLY
 Prepared By:
Tiffany Hoffman
 Ohio County Assessor

Legend	
Property Line	Original Lot Line
Road Right of Way	Lot Number (15)
Corporation Line	Parcel Number (99)
District Line	Water
County Line	Railroad

R	1	Revised 9/3/2019	9		17
O	2	Revised 01/28/2020			18
V	3	Revised 01/28/2021			19
I	4	Revised 01/28/2022			20
S	5				21
I	6				22
O	7				23
N	8				24

STATE OF WEST VIRGINIA
COUNTY OF OHIO
 Office of Assessor

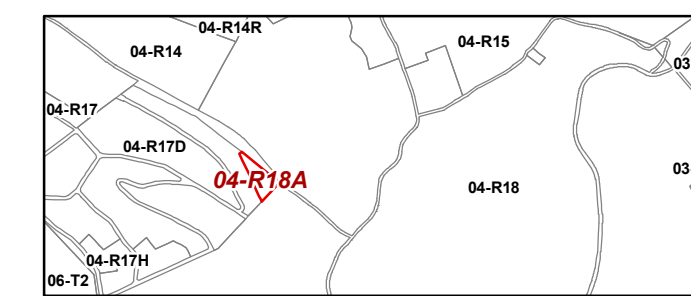

Richland
 Map: R18A
 Date, Aerial Photography: 2015
 Date, Map: 1/28/2022
 Scale: 1" = 100'