

FOR TAX PURPOSES ONLY  
 Prepared By:  
**Tiffany Hoffman**  
 Ohio County Assessor

| Legend            |                    |
|-------------------|--------------------|
| Property Line     | Original Lot Line  |
| Road Right of Way | Lot Number (15)    |
| Corporation Line  | Parcel Number (99) |
| District Line     | Water              |
| County Line       | Railroad           |

|   |   |                    |    |  |    |
|---|---|--------------------|----|--|----|
| R | 1 | Revised 9/3/2019   | 9  |  | 17 |
| e | 2 | Revised 01/28/2020 | 10 |  | 18 |
| v | 3 | Revised 01/28/2021 | 11 |  | 19 |
| i | 4 | Revised 01/28/2022 | 12 |  | 20 |
| s | 5 |                    | 13 |  | 21 |
| t | 6 |                    | 14 |  | 22 |
| n | 7 |                    | 15 |  | 23 |
| s | 8 |                    | 16 |  | 24 |

**STATE OF WEST VIRGINIA**  
**COUNTY OF OHIO**  
 Office of Assessor

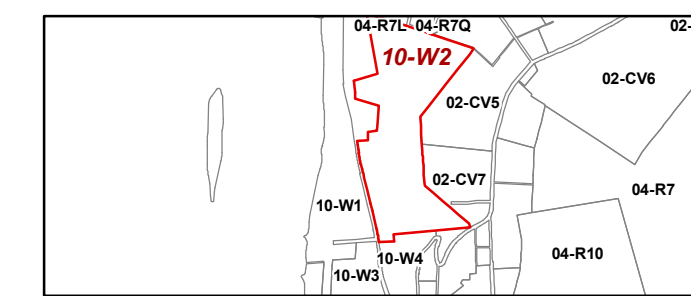

Wheeling  
 Map: W2  
 Date, Aerial Photography: 2015  
 Date, Map: 1/28/2022  
 Scale: 1" = 100'