

FOR TAX PURPOSES ONLY
 Prepared By:
Tiffany Hoffman
 Ohio County Assessor

Legend	
Property Line	Original Lot Line
Road Right of Way	Lot Number (15)
Corporation Line	Parcel Number (99)
District Line	Water
County Line	Railroad

R	1	Revised 9/3/2019	9	17
O	2	Revised 01/28/2020	10	18
V	3	Revised 01/28/2021	11	19
I	4	Revised 01/28/2022	12	20
S	5		13	21
J	6		14	22
O	7		15	23
N	8		16	24

STATE OF WEST VIRGINIA
COUNTY OF OHIO
 Office of Assessor

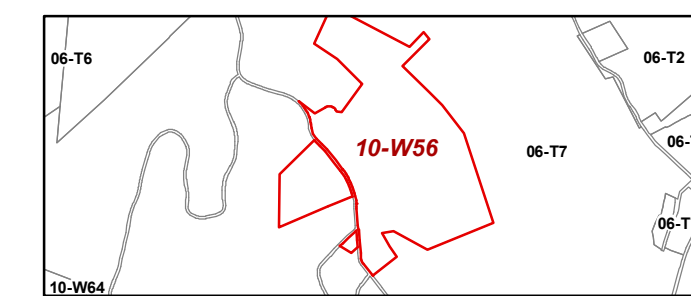

Wheeling
 Map: W56
 Date, Aerial Photography: 2015
 Date, Map: 1/28/2022
 Scale: 1" = 100'