

FOR TAX PURPOSES ONLY  
 Prepared By:  
**Tiffany Hoffman**  
 Ohio County Assessor

**Legend**

Property Line	—	Original Lot Line	—
Road Right of Way	—	Lot Number	(15)
Corporation Line	—	Parcel Number	(99)
District Line	—	Water	—
County Line	—	Railroad	—

R	1	Revised 9/3/2019	9	17
e	2	Revised 6/28/2020	11	18
v	3	Revised 6/28/2021	12	19
i	4	Revised 01/28/2022	13	20
s	5		14	21
t	6		15	22
n	7		16	23
o	8		17	24

**STATE OF WEST VIRGINIA**  
**COUNTY OF OHIO**  
 Office of Assessor

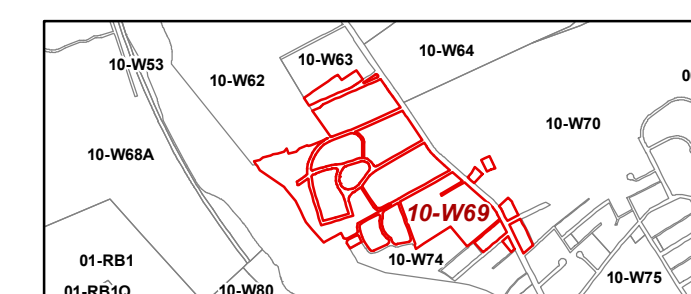

Wheeling  
 Map: W69  
 Date, Aerial Photography: 2015  
 Date, Map: 1/28/2022  
 Scale: 1" = 100'