

FOR TAX PURPOSES ONLY
 Prepared By:
Tiffany Hoffman
 Ohio County Assessor

Legend	
Property Line	Original Lot Line
Road Right of Way	Lot Number (15)
Corporation Line	Parcel Number (99)
District Line	Water
County Line	Railroad

R	1	Revised 9-3-2019	9		17
O	2	Revised 01-28-2020	10		18
V	3	Revised 01-28-2021	11		19
I	4	Revised 01-28-2021	12		20
S	5	Revised 01-28-2022	13		21
I	6		14		22
O	7		15		23
N	8		16		24

STATE OF WEST VIRGINIA
COUNTY OF OHIO
 Office of Assessor

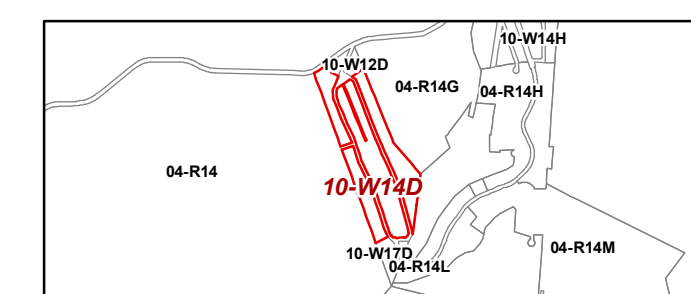

Wheeling
 Map: W14D
 Date, Aerial Photography: 2015
 Date, Map: 1/28/2022
 Scale: 1" = 100'