

# HARDY COUNTY PENDELTON COUNTY

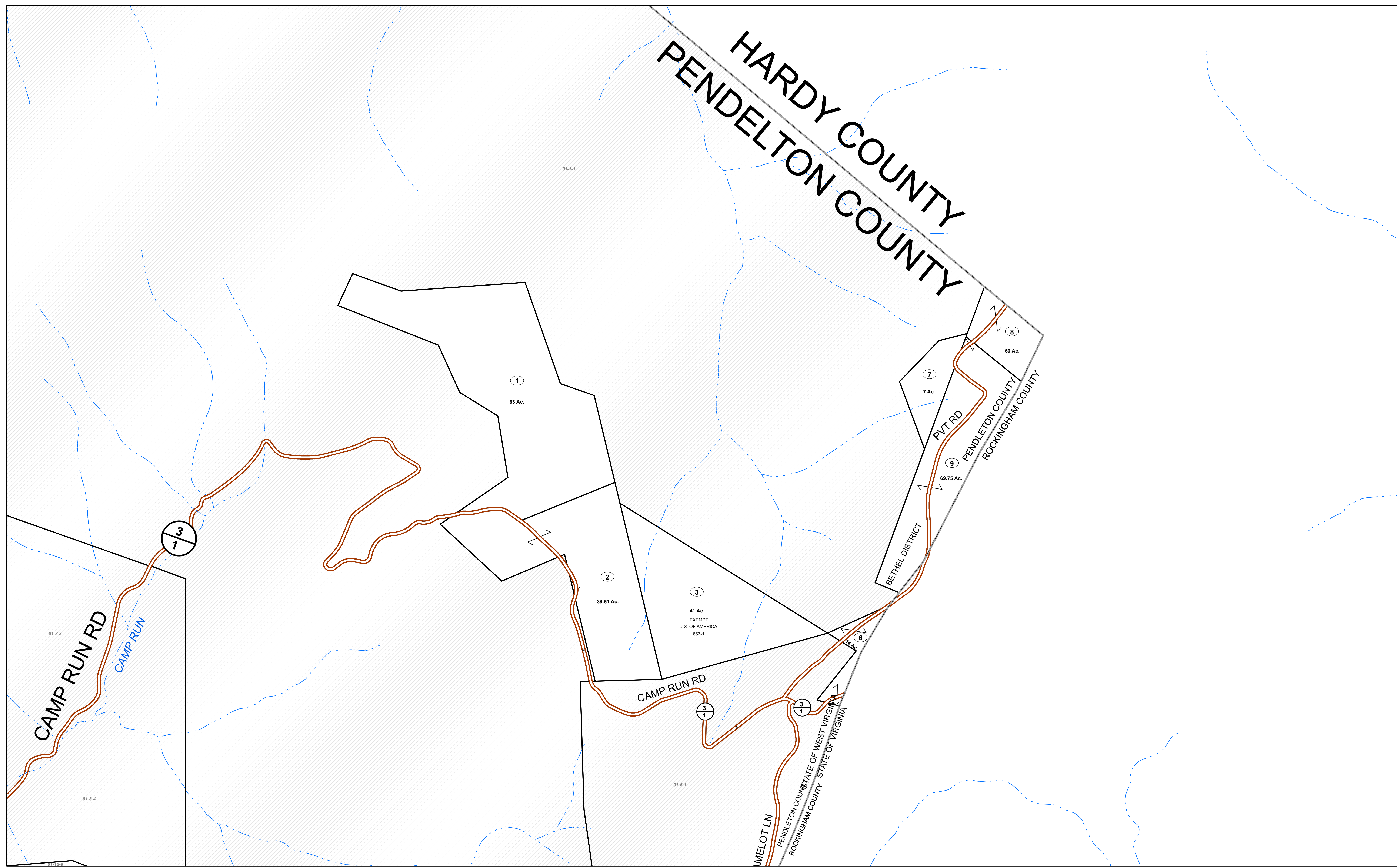

FOR TAX PURPOSES ONLY  
Prepared By:  
**Sandie H Smith**  
Pendleton County Assessor

**Legend**

Property Line	Original Lot Line
Road Right of Way	Lot Number (15)
Corporation Line	Parcel Number (99)
District Line	Water
County Line	Railroad

R	1	Revised 10/1/16	9		17
O	2	Revised 1/30/2019	10		18
V	3	Revised 1/30/2020	11		19
I	4	Revised 1/26/2021	12		20
S	5	Revised 1/26/2022	13		21
J	6		14		22
O	7		15		23
N	8		16		24

**STATE OF WEST VIRGINIA**  
**COUNTY OF PENDELTON**  
Office of Assessor

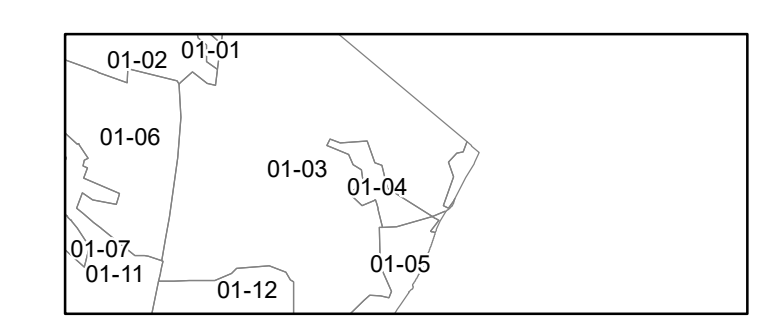

**BETHEL**  
Map: 4  
Date, Aerial Photography: 2015  
Date, Map: 1/25/2022  
Scale: 1" = 400'