

# CITY OF HURRICANE

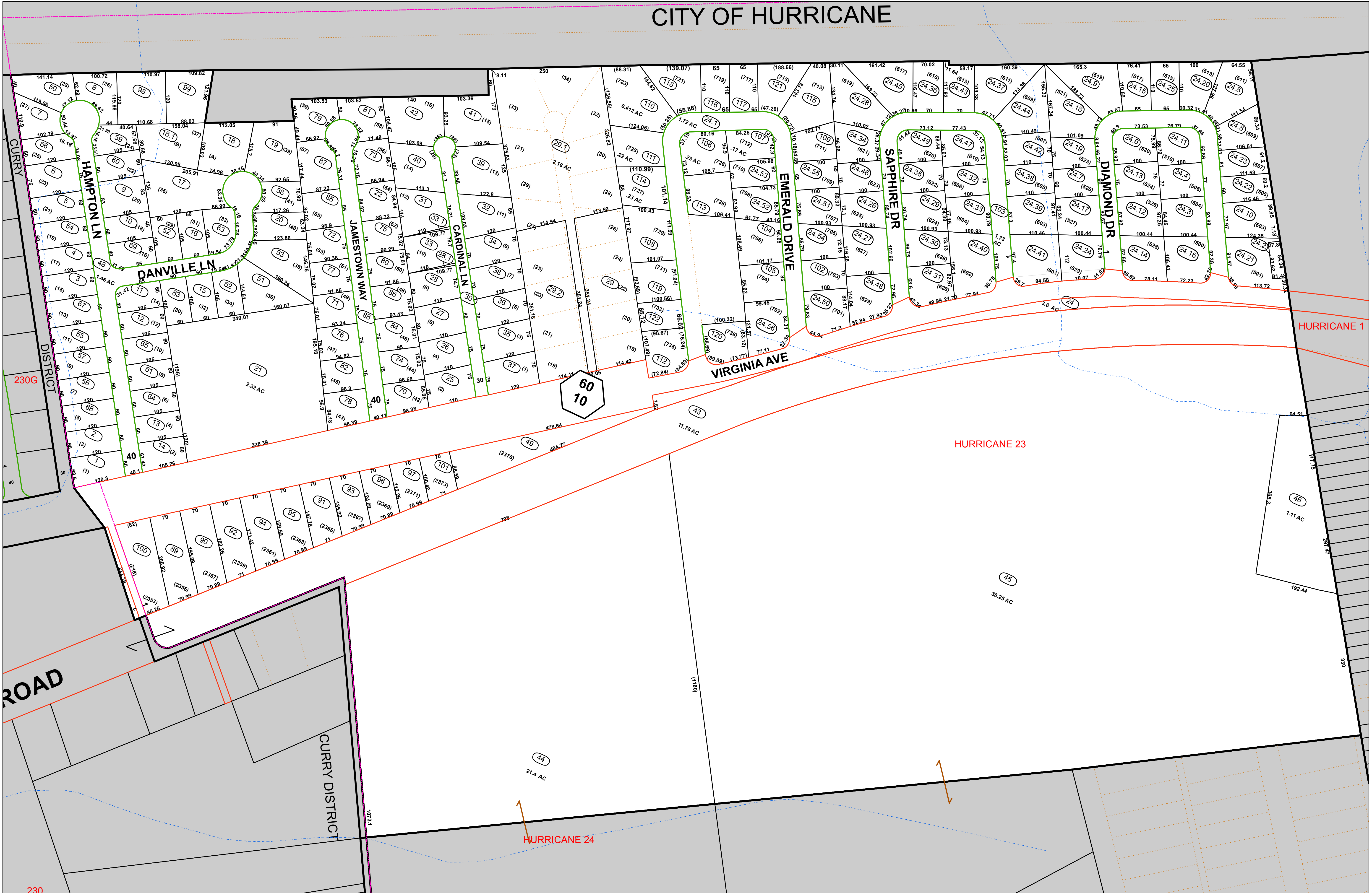

230

PREPARED BY  
THE MAPPING / GIS STAFF OF:  
**GARY WARNER**  
PUTNAM COUNTY ASSESSOR  
3389 WINFIELD ROAD  
WINFIELD, WV 25213  
PHONE: (304) 586-0206  
FAX: (304) 586-0226

Date: 1/18/2022

**FOR TAX PURPOSES ONLY**  
ALL TAX MAPS CREATED UNDER THE PROVISIONS OF REAPPRAISAL LEGISLATION ARE THE PROPERTY OF PUTNAM COUNTY WEST VIRGINIA AND THE REPRODUCTION, COPYING, DISTRIBUTION OR SALE OF SUCH TAX MAPS OR ANY COPIES THEREOF WITHOUT THE WRITTEN PERMISSION OF THE PUTNAM COUNTY ASSESSOR IS PROHIBITED BY LAW.

LEGEND

Road ROW	Parcel Boundary	Utility_Easement
Parcel Hook	Lot line/Easement	Parcel Number
Road-Rail ROW	Parcel-Road ROW	Routing Number
District	MapBooks	Deed Lot Number
Rivers/Lakes		

Revisions

1. 10/26/2021 UPDATE (JSH)
2. 1/1/2019 UPDATE SUPPLIED TO STATE (JSH)
3. 1/14/2015 UPDATE SUPPLIED TO STATE (BAS)
4. 1/7/2016 UPDATE SUPPLIED TO STATE (BAS)
5. 1/7/2017 UPDATE SUPPLIED TO STATE (BAS)
6. 2/14/2017
7. 1/8/18 UPDATE SUPPLIED TO STATE (JSH)

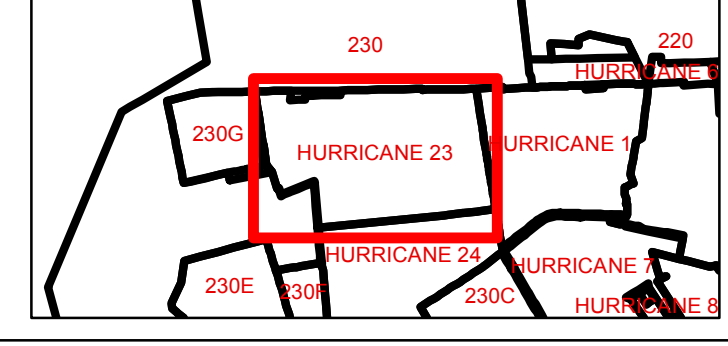

**PUTNAM COUNTY**  
STATE OF WEST VIRGINIA  
OFFICE OF ASSESSOR

Sheet No.: **HURRICANE 23**  
District: HURRICANE TOWN  
Date, Aerial Photography: 2021  
Scale: 1" = 100'