



PREPARED BY  
 THE MAPPING / GIS STAFF OF:  
**GARY WARNER**  
**PUTNAM COUNTY ASSESSOR**  
 3389 WINFIELD ROAD  
 WINFIELD, WV 25213  
 PHONE: (304) 586-0206  
 FAX: (304) 586-0226  
 Date: 1/18/2022

**FOR TAX PURPOSES ONLY**  
 ALL TAX MAPS CREATED UNDER THE PROVISIONS OF  
 REAPPRAISAL LEGISLATION ARE THE PROPERTY OF  
 PUTNAM COUNTY WEST VIRGINIA AND THE  
 REPRODUCTION, COPYING, DISTRIBUTION OR SALE  
 OF SUCH TAX MAPS OR ANY COPIES THEREOF  
 WITHOUT THE WRITTEN PERMISSION OF THE PUTNAM  
 COUNTY ASSESSOR IS PROHIBITED BY LAW.

LEGEND		
	Road ROW	
	Parcel Boundary	
	Road-Rail ROW	
	District	
	Rivers/Lakes	
	Parcel Hook	
	Lot line/Easement	
	Parcel-Road ROW	
	MapBooks	
	Utility Easement	
	Parcel Number	
	Routing Number	
	Deed Lot Number	

Revisions
1. 10/26/2021 UPDATE (JSH)
2. 1/1/2019 UPDATE SUPPLIED TO STATE (JSH)
3. 1/14/2015 UPDATE SUPPLIED TO STATE (BAS)
4. 1/7/2016 UPDATE SUPPLIED TO STATE (BAS)
5. 1/7/2017 UPDATE SUPPLIED TO STATE (BAS)
6. 2/14/2017
7. 1/8/18 UPDATE SUPPLIED TO STATE (JSH)

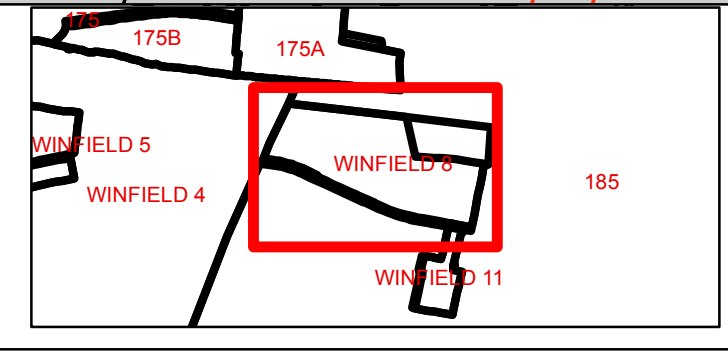

**PUTNAM COUNTY**  
 STATE OF WEST VIRGINIA  
 OFFICE OF ASSESSOR

Sheet No.: **WINFIELD 8**  
 District: WINFIELD TOWN  
 Date, Aerial Photography: 2021  
 Scale: 1" = 100'