

Legend	
	District Boundary
	Property
	Road Easement
	Railroad Right of Way
	Road Right of Way
	River
	Deed lot Number
	Parcel or Index Number
	UNKNOWN
	Improvement
	Cemetery
	School
	Church

Restriction

All tax maps created under the provisions of reappraisal legislation are the property of the Assessor of Randolph County, West Virginia and the reproduction, copying, modification, distribution or sale of such tax maps or any copies thereof without the written permission of the Randolph County Assessor is prohibited by law.

Revisions					
1	6-30-1964	10	P.K.Y. 7-1-2002	19	
2	T.R.L. 7-1980	11	P.K.Y. 7-1-2003	20	
3	D.F. 7-1-1989	12	P.K.Y. 7-1-2004	21	
4	OGIS T.L. 4-30-1992	13	A.K.B. 7-1-2007	22	
5	OGIS S.A.J. 4-30-1993	14	A.K.B. 7-1-2008	23	
6	OGIS R.R.O. 3-1994	15	S.T.P. 7-1-2013	24	
7	OGIS J.E.B. 5-1-1996	16		25	
8	SLS INC. J.W.M. 3-1997	17		26	
9	P.K.Y. 7-1-2000	18		27	
				28	
				29	
				30	
				31	
				32	
				33	
				34	
				35	
				36	

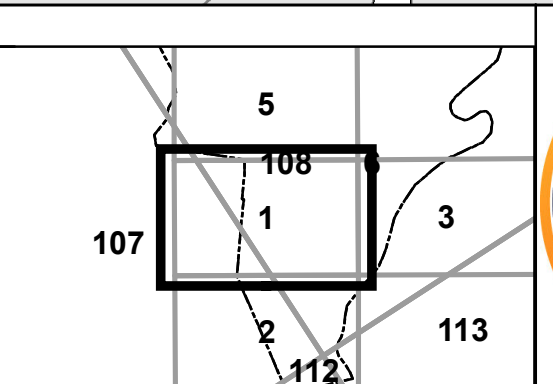

RANDOLPH COUNTY HUTTONSVILLE CORP
 Assessor's Office
 Phyllis K. Yokum, Assessor
 ELKINS, WV

District 08 Map No. 1
 Date of Publication: 1/18/2022
 Scale: 1"=100'