

Legend	
	District Boundary
	Previous Deed
	Property
	Road Easement
	Railroad Right of Way
	Road Right of Way
	River
	Deed lot Number (15)
	Parcel or Index Number (9)
	UNKNOWN
	Improvement
	Cemetery
	School
	Church

**Restriction**

All tax maps created under the provisions of reappraisal legislation are the property of the Assessor of Randolph County, West Virginia and the reproduction, copying, modification, distribution or sale of such tax maps or any copies thereof without the written permission of the Randolph County Assessor is prohibited by law.

Revisions					
1	6-30-1964	10	P.K.Y. 7-1-2003	19	
2	D.R. 7-1980	11		20	
3	N.S. 3-1981	12		21	
4	T.R.L. 7-1984	13		22	
5	C.P. 7-1-1985	14		23	
6	R.E.B. 7-1-1989	15		24	
7	OGIS J.E.B. 4-15-1992	16		25	
8	OGIS J.E.B. 5-1-1996	17		26	
9	P.K.Y. 7-1-2001	18		27	
				28	
				29	
				30	
				31	
				32	
				33	
				34	
				35	
				36	

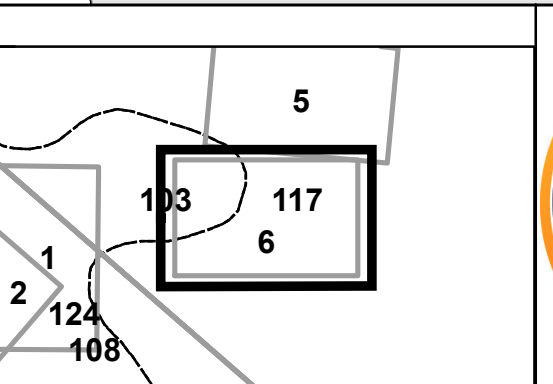

**RANDOLPH COUNTY**  
 Assessor's Office  
 Phyllis K. Yokum, Assessor  
 ELKINS, WV

**LEADSVILLE**  
 District 10 Map No. 6  
 Date of Publication: 1/18/2022  
 Scale: 1"=100'