

SPENCER CORPORATION SPENCER DISTRICT

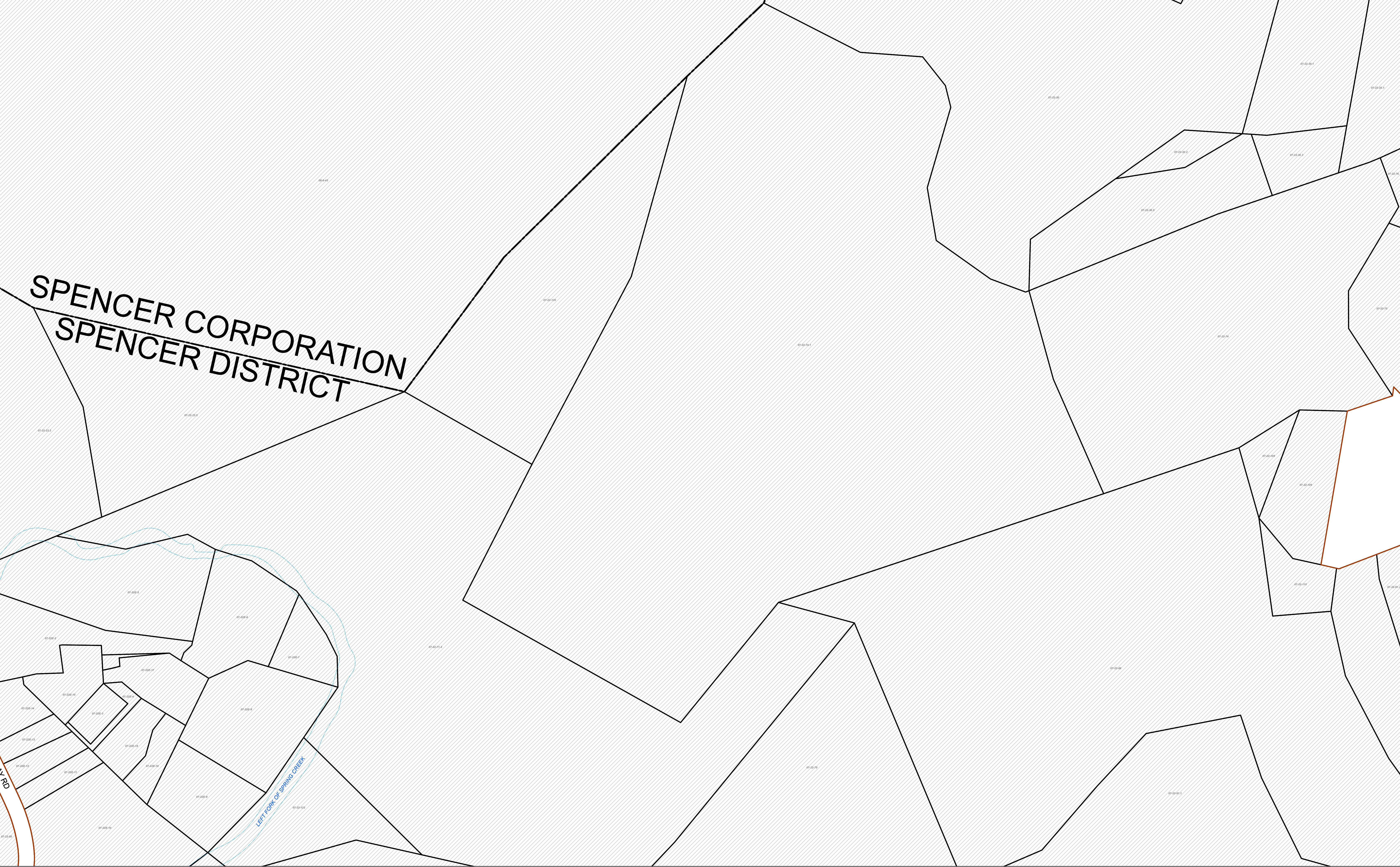

WAY RD

LEFT FORK OF SPRING CREEK

FOR TAX PURPOSES ONLY

Prepared By:
Emily C Westfall
Roane County Assessor

Legend	
Property Line	Original Lot Line
Road Right of Way	Lot Number (15)
Corporation Line	Parcel Number (99)
District Line	Water
County Line	Railroad

1	Revised 2/11/2021	9	17
2		10	18
3		11	19
4		12	20
5		13	21
6		14	22
7		15	23
8		16	24

STATE OF WEST VIRGINIA
COUNTY OF ROANE
Office of Assessor

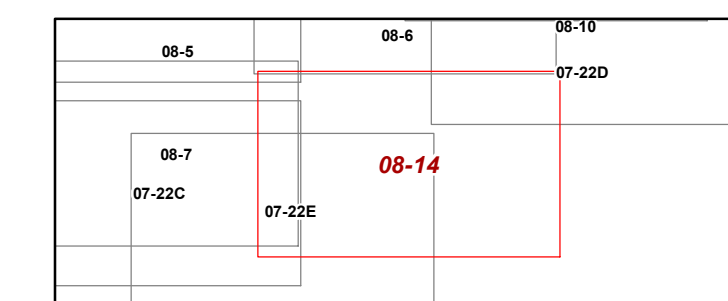

SPENCER CORPORATION
Map: 14
Date, Aerial Photography: 2019
Date, Map: 2/15/2021
Scale: 1 inch = 100 feet