

UNITED STATES OF AMERICA

OF AMERICA

UNITED STATES OF AMERICA

JUMPING BRANCH DISTRICT

PIPESTEM DISTRICT

PIPESTEM DISTRICT

JUMPING BRANCH DISTRICT

ALBERT HILL RD

18

S SR 20

44

20

S SR 20

18

FOR TAX PURPOSES ONLY

Prepared By:

Greg Vandall
Summers County Assessor

Legend	
Property Line	Original Lot Line
Road Right of Way	Lot Number (15)
Corporation Line	Parcel Number (99)
District Line	Water
County Line	Railroad

R	1	Revised 6/3/16	9	17
O	2	Revised 12/30/2016	10	18
V	3	Revised 03/30/2018	11	19
J	4	Revised 02/24/2021	12	20
S	5	Revised 01/27/2022	13	21
I	6		14	22
O	7		15	23
n	8		16	24

STATE OF WEST VIRGINIA
COUNTY OF SUMMERS
Office of Assessor

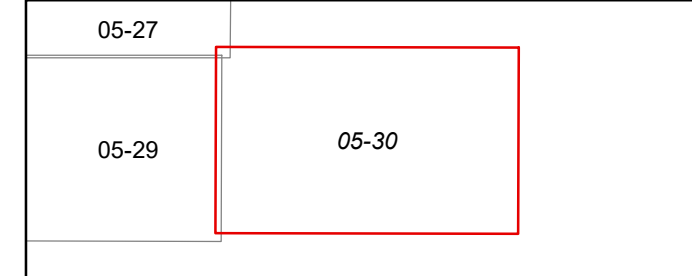

JUMPING BRANCH DISTRICT
Map: 30
Date, Aerial Photography: 2003
Date, Map: 1/31/2022
Scale: 1" = 400'