

FOR TAX PURPOSES ONLY

Prepared By:  
**Greg Vandall**  
 Summers County Assessor

**Legend**

Property Line	—	Original Lot Line	---
Road Right of Way	—	Lot Number (15)	---
Corporation Line	—	Parcel Number (99)	---
District Line	—	Water	---
County Line	—	Railroad	---

R	1	Revised 6/1/16	9		17
0	2	Revised 12/30/2016	10		18
V	3	Revised 02/26/2018	11		19
I	4	Revised 10/29/2020	12		20
S	5	Revised 02/24/2021	13		21
I	6	Revised 01/27/2022	14		22
o	7		15		23
n	8		16		24
s					

**STATE OF WEST VIRGINIA**  
**COUNTY OF SUMMERS**  
 Office of Assessor

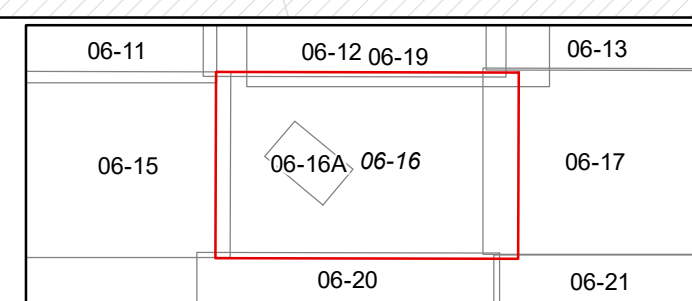

**PIPESTEM DISTRICT**  
 Map: 16  
 Date, Aerial Photography: 2018  
 Date, Map: 1/31/2022  
 Scale: 1" = 400'