

**FOR TAX PURPOSES ONLY**

**Legend**

--- District Boundary	Dead lot Number (15)
--- Previous Deed	Parcel or Index Number (9)
--- Property	Unknown (1)
--- Road Easement	Improvement (1)
--- Railroad Right of Way	Cemetery (1)
--- Road Right of Way	Church (1)
--- River	Educational (1)

**Restriction**

REPRODUCTION OF TAX MAPS PROHIBITED - It is unlawful to copy, photology, scan, photograph, or otherwise reproduce this tax map. Pursuant to the provisions of W.Va. CSR § 189-5-5 (2013) no person may reproduce, copy, distribute or sell copies of tax maps prepared by the counties without having first obtained the written permission of the Taylor County Assessor. In addition to other penalties and civil remedies, any person who, without the written permission of the Taylor County Assessor, reproduces, copies, distributes, or sells or who allows the reproduction, copying, distribution or sale of tax maps prepared by the Taylor County Assessor, shall be refused permission by the Taylor County Assessor or Assessor's agent to purchase tax maps in the future.

**Revisions**

1	Revised 12/30/2016	10	19	28
2	Revised 12/30/2019	11	20	29
3	Revised 02/17/2021	12	21	30
4	Revised 01/20/2022	13	22	31
5		14	23	32
6		15	24	33
7		16	25	34
8		17	26	35
9		18	27	36

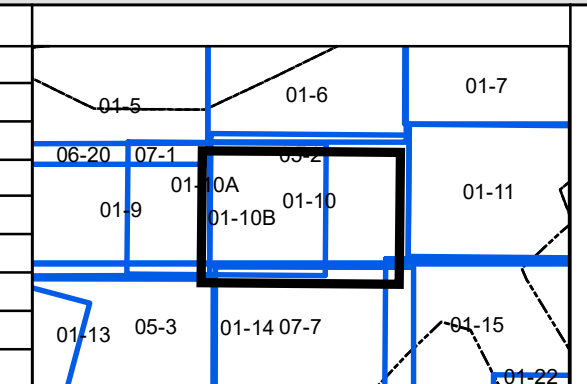

**Taylor County**  
 Assessor's Office  
 Christa Kinsey, Assessor  
 Grafton, WV

**GRAFTON CORP**  
 District: 01 Map No: 10B  
 Date of Publication: 1/20/2022  
 Scale: 1" = 200'