

CABELL COUNTY
WAYNE COUNTY

FOR TAX PURPOSES ONLY
Prepared By:
Rick Browning
Wayne County Assessor

Legend	
Property Line	Original Lot Line
Road Right of Way	Lot Number (15)
Corporation Line	Parcel Number (99)
District Line	Water
County Line	Railroad

R	1	Revised 9/3/2019	9	17
e	2	Revised 01/28/2020	11	18
v	3	Revised 01/28/2021	12	19
i	4	Revised 01/28/2022	13	20
s	5		14	21
t	6		15	22
o	7		16	23
n	8			24

STATE OF WEST VIRGINIA
COUNTY OF WAYNE
Office of Assessor

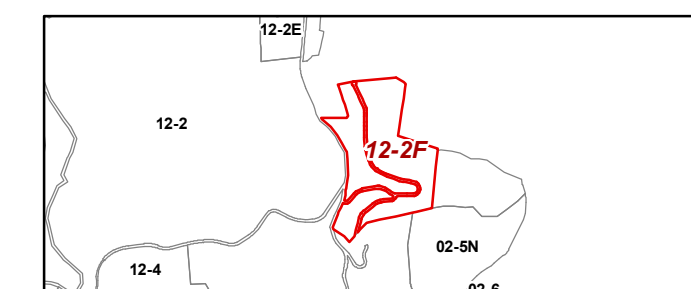

WESTMORELAND
Map: 2F
Date, Aerial Photography: 2019
Date, Map: 1/25/2022
Scale: 1" = 100'