



FOR TAX PURPOSES ONLY

Prepared By:
Max Cochran
 Webster County Assessor

Legend

Property Line	Original Lot Line
Road Right of Way	Lot Number (15)
Corporation Line	Parcel Number (99)
District Line	Water
County Line	Railroad

R	11	Revised 04/01/2018	9	17
O	2	Revised 01/22/2020	10	18
V	3	Revised 03/17/2021	11	19
I	4	Revised 01/22/2022	12	20
S	5		13	21
I	6		14	22
O	7		15	23
N	8		16	24

STATE OF WEST VIRGINIA
COUNTY OF WEBSTER
 Office of Assessor

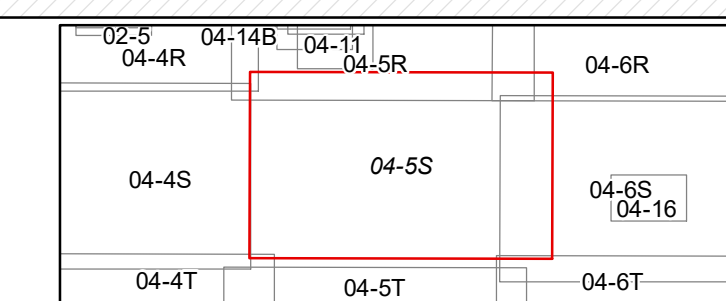

GLADE
 Map: 5S
 Date, Aerial Photography: 2003
 Date, Map: 1/27/2022
 Scale: 1" = 400'