

FOR TAX PURPOSES ONLY

Prepared By:
Max Cochran
 Webster County Assessor

Legend

Property Line	Original Lot Line
Road Right of Way	Lot Number (15)
Corporation Line	Parcel Number (99)
District Line	Water
County Line	Railroad

R	1	Revised 04/01/2018	9		17
O	2	Revised 01/22/2020	10		18
V	3	Revised 03/17/2021	11		19
J	4	Revised 01/22/2022	12		20
S	5		13		21
I	6		14		22
O	7		15		23
N	8		16		24

STATE OF WEST VIRGINIA
COUNTY OF WEBSTER
 Office of Assessor

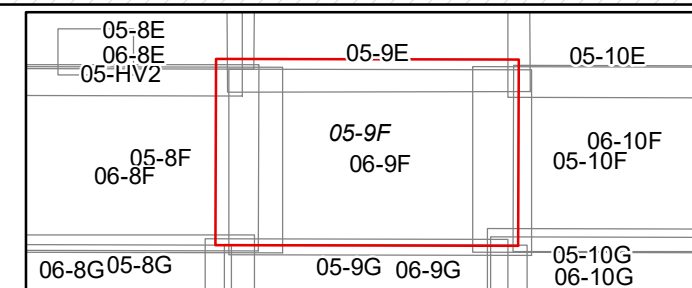

HACKER VALLEY
 Map: 9F
 Date, Aerial Photography: 2003
 Date, Map: 1/27/2022
 Scale: 1" = 400'