

FOR TAX PURPOSES ONLY

Prepared By:

**Max Cochran**  
Webster County Assessor

Legend	
Property Line	Original Lot Line
Road Right of Way	Lot Number (15)
Corporation Line	Parcel Number (99)
District Line	Water
County Line	Railroad

R	1	Revised 04/01/2018	9	17
O	2	Revised 01/22/2020	10	18
V	3	Revised 02/17/2021	11	19
J	4	Revised 01/22/2022	12	20
S	5		13	21
I	6		14	22
O	7		15	23
N	8		16	24

**STATE OF WEST VIRGINIA**  
**COUNTY OF WEBSTER**  
Office of Assessor

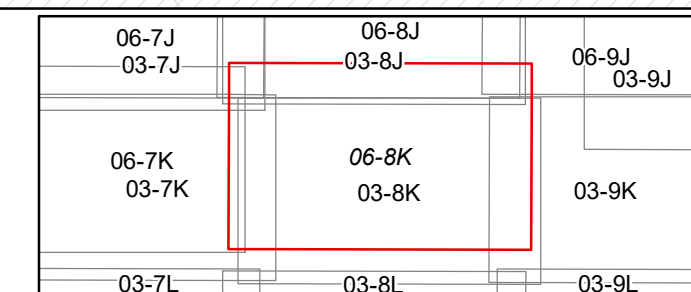

**HOLLY**  
**Map: 8K**

Date, Aerial Photography: 2003

Date, Map: 1/27/2022

Scale: 1" = 400'