

LIDAR FOR MAP AMENDMENT: Bldg ID 32-09-0011-0034-0000_8374

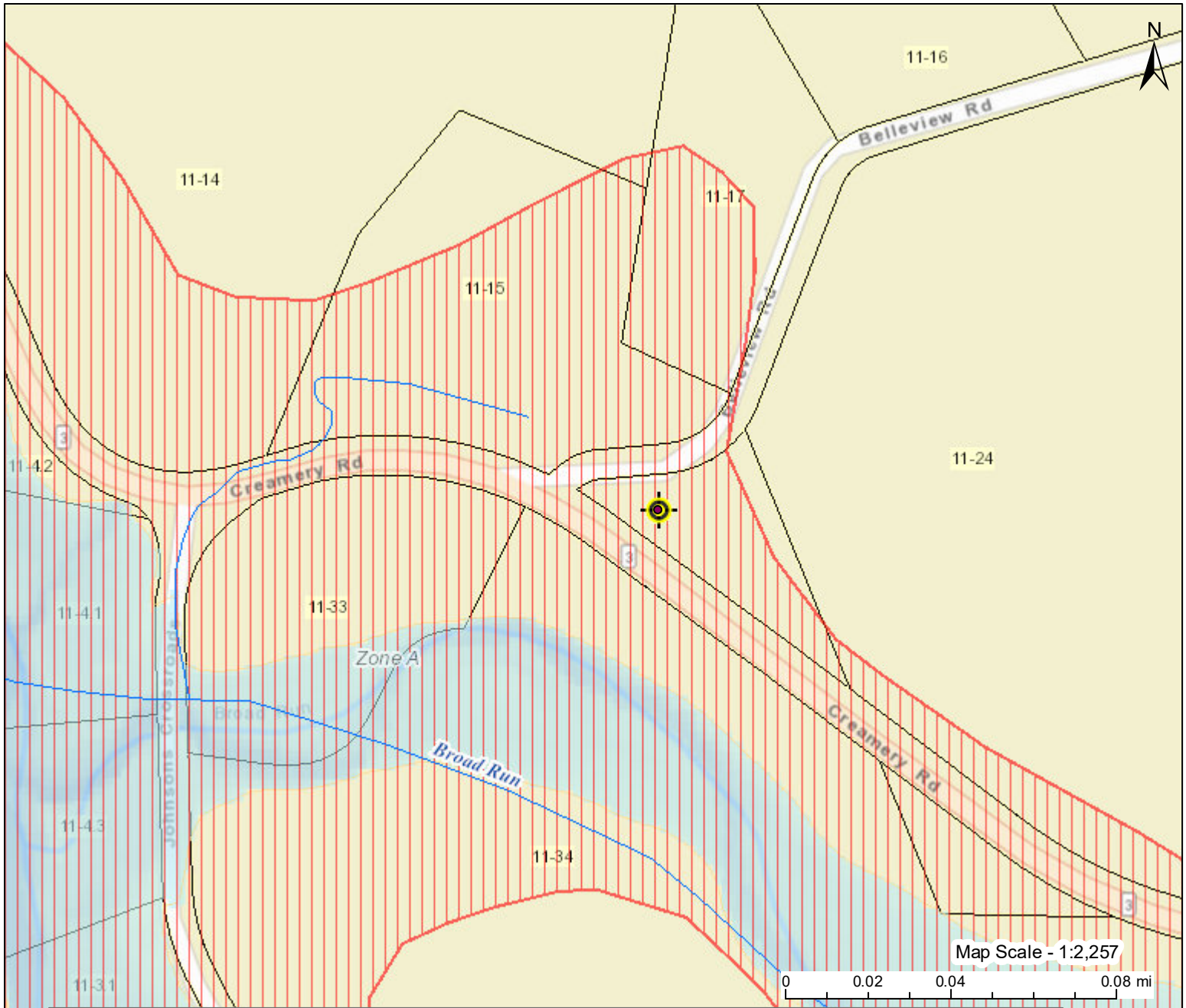

This map is not the official regulatory FIRM or DFIRM. Its purpose is to assist with determining potential flood risk for the selected location.

H I G H R I S K		1-Percent-Annual-Chance Flood Hazard Area With Base Flood Elevation (BFE)
		Regulatory Floodway in AE Zone
		1-Percent-Annual-Chance Flood Hazard Area Without BFE (may have Advisory Flood Heights)
		1-Percent-Annual-Chance High Risk Advisory

Download the Full Legend for all flood tool symbols
https://www.mapwv.gov/flood/map/docs/wv_flood_tool_legend.pdf

Disclaimer:
 The online map is for use in administering the National Flood Insurance Program. It does not necessarily identify all areas subject to flooding, particularly from local drainage sources of small size. Refer to the official Flood Insurance Study (FIS) for detailed flood elevation data in flood profiles and data tables. WV Flood Tool (<https://www.mapwv.gov/flood>) is supported by FEMA, WV NFIP Office, and WV GIS Technical Center.

	Flood Info Location	Map created on 11/8/2020
User	Street map reference for LiDAR for Map Amendment. ADDRESS: 8374 WOLF CREEK RD, Sinks Grove, WV, 24976	
Notes	8374 WOLF CREEK RD, Sinks Grove, WV, 24976	
Flood Hazard Area	Location is WITHIN the FEMA 100-year floodplain.	
Flood Zone	A	
Stream	Broad Run	
Watershed (HUC8)	Greenbrier (5050003)	
Flood Height		
Water Depth		
Elevation	1617.4 ft (Source: FEMA 2016) (NAVD88)	
Community & ID	Monroe County (ID: 540278)	
FEMA Map & Date	54063C0040C; Effective Date: 6/17/2002	
Location (lat, long)	(37.665526, -80.622467) (WGS84)	
Parcel ID	32-09-0011-0034-0000	
E-911 Address	8374 WOLF CREEK RD, Sinks Grove, WV, 24976	