

National Flood Insurance Program

Elevation Certificate

and Instructions

2023 EDITION



FEMA

ELEVATION CERTIFICATE AND INSTRUCTIONS

PAPERWORK REDUCTION ACT NOTICE

Public reporting burden for this data collection is estimated to average 3.75 hours per response. The burden estimate includes the time for reviewing instructions, searching existing data sources, gathering and maintaining the data needed, and completing and submitting this form. You are not required to respond to this collection of information unless a valid OMB control number is displayed on this form. Send comments regarding the accuracy of the burden estimate and any suggestions for reducing the burden to: Information Collections Management, Department of Homeland Security, Federal Emergency Management Agency, 500 C Street SW, Washington, DC 20742, Paperwork Reduction Project (1660-0008). **NOTE: Do not send your completed form to this address.**

PRIVACY ACT STATEMENT

Authority: Title 44 CFR § 61.7 and 61.8.

Principal Purpose(s): This information is being collected for the primary purpose of documenting compliance with National Flood Insurance Program (NFIP) floodplain management ordinances for new or substantially improved structures in designated Special Flood Hazard Areas. This form may also be used as an optional tool for a Letter of Map Amendment (LOMA), Conditional LOMA (CLOMA), Letter of Map Revision Based on Fill (LOMR-F), or Conditional LOMR-F (CLOMR-F), or for flood insurance rating purposes in any flood zone.

Routine Use(s): The information on this form may be disclosed as generally permitted under 5 U.S.C. § 552a(b) of the Privacy Act of 1974, as amended. This includes using this information as necessary and authorized by the routine uses published in DHS/ FEMA-003 – *National Flood Insurance Program Files System of Records Notice 79 Fed. Reg. 28747 (May 19, 2014)* and upon written request, written consent, by agreement, or as required by law.

Disclosure: The disclosure of information on this form is voluntary; however, failure to provide the information requested may impact the flood insurance premium through the NFIP. Information will only be released as permitted by law.

PURPOSE OF THE ELEVATION CERTIFICATE

The Elevation Certificate is an important administrative tool of the NFIP. It can be used to provide elevation information necessary to ensure compliance with community floodplain management ordinances, to inform the proper insurance premium, and to support a request for a LOMA, CLOMA, LOMR-F, or CLOMR-F.

The Elevation Certificate is used to document floodplain management compliance for Post-Flood Insurance Rate Map (FIRM) buildings, which are buildings constructed after publication of the FIRM, located in flood Zones A1–A30, AE, AH, AO, A (with Base Flood Elevation (BFE)), VE, V1–V30, V (with BFE), AR, AR/A, AR/AE, AR/A1–A30, AR/AH, AR/AO, and A99. It may also be used to provide elevation information for Pre-FIRM buildings or buildings in any flood zone.

As part of the agreement for making flood insurance available in a community, the NFIP requires the community to adopt floodplain management regulations that specify minimum requirements for reducing flood losses. One such requirement is for the community to obtain the elevation of the lowest floor (including basement) of all new and substantially improved buildings, and maintain a record of such information. The Elevation Certificate provides a way for a community to document compliance with the community's floodplain management ordinance.

Use of this certificate does not provide a waiver of the flood insurance purchase requirement. Only a LOMA or LOMR-F from the Federal Emergency Management Agency (FEMA) can amend the FIRM and remove the federal mandate for a lending institution to require the purchase of flood insurance. However, the lending institution has the option of requiring flood insurance even if a LOMA/LOMR-F has been issued by FEMA. The Elevation Certificate may be used to support a LOMA, CLOMA, LOMR-F, or CLOMR-F request. Lowest Adjacent Grade (LAG) elevations certified by a land surveyor, engineer, or architect, as authorized by state law, will be required if the certificate is used to support a LOMA, CLOMA, LOMR-F, or CLOMR-F request. A LOMA, CLOMA, LOMR-F, or CLOMR-F request must be submitted with either a completed FEMA MT-EZ or MT-1 application package, whichever is appropriate. If the certificate will only be completed to support a LOMA, CLOMA, LOMR-F, or CLOMR-F request, there is an option to document the certified LAG elevation on the Elevation Form included in the MT-EZ and MT-1 application.

This certificate is used only to certify building elevations. A separate certificate is required for floodproofing. Under the NFIP, non-residential buildings can be floodproofed up to or above the BFE. A floodproofed building is a building that has been designed and constructed to be watertight (substantially impermeable to floodwaters) below the BFE. Floodproofing of residential buildings is not permitted under the NFIP unless FEMA has granted the community an exception for residential floodproofed basements. The community must adopt standards for design and construction of floodproofed basements before FEMA will grant a basement exception. For both floodproofed non-residential buildings and residential floodproofed basements in communities that have been granted an exception by FEMA, a floodproofing certificate is required.

The expiration date on the form herein does not apply to certified and completed Elevation Certificates, as a completed Elevation Certificate does not expire, unless there is a physical change to the building that invalidates information in Section A Items A8 or A9, Section C, Section E, or Section H. In addition, this form is intended for the specific building referenced in Section A and is not invalidated by the transfer of building ownership.

Additional guidance can be found in FEMA Publication 467-1, *Floodplain Management Bulletin: Elevation Certificate*.

ELEVATION CERTIFICATE

IMPORTANT: MUST FOLLOW THE INSTRUCTIONS ON INSTRUCTION PAGES 1-11

Copy all pages of this Elevation Certificate and all attachments for (1) community official, (2) insurance agent/company, and (3) building owner.

SECTION A – PROPERTY INFORMATION		FOR INSURANCE COMPANY USE
A1. Building Owner's Name: <u>BILLY DAVIS</u>		Policy Number: _____
A2. Building Street Address (including Apt., Unit, Suite, and/or Bldg. No.) or P.O. Route and Box No.: <u>1241 BUFFALO CALF ROAD</u>		Company NAIC Number: _____
City: <u>SALEM</u> State: <u>WV</u> ZIP Code: <u>26426</u>		
A3. Property Description (e.g., Lot and Block Numbers or Legal Description) and/or Tax Parcel Number: <u>GREENBRIER DISTRICT, TAX MAP 3, PARCEL 21 (BUFFALO CALF; 57.56 AC)</u>		
A4. Building Use (e.g., Residential, Non-Residential, Addition, Accessory, etc.): <u>RESIDENTIAL</u>		
A5. Latitude/Longitude: Lat. <u>39.258774</u> Long. <u>-80.626920</u> Horiz. Datum: <input type="checkbox"/> NAD 1927 <input type="checkbox"/> NAD 1983 <input checked="" type="checkbox"/> WGS 84		
A6. Attach at least two and when possible four clear color photographs (one for each side) of the building (see Form pages 7 and 8).		
A7. Building Diagram Number: <u>6</u>		
A8. For a building with a crawlspace or enclosure(s):		
a) Square footage of crawlspace or enclosure(s): <u>1012</u> sq. ft.		
b) Is there at least one permanent flood opening on two different sides of each enclosed area? <input checked="" type="checkbox"/> Yes <input type="checkbox"/> No <input type="checkbox"/> N/A		
c) Enter number of permanent flood openings in the crawlspace or enclosure(s) within 1.0 foot above adjacent grade: Non-engineered flood openings: <u>N/A</u> Engineered flood openings: <u>N/A</u>		
d) Total net open area of non-engineered flood openings in A8.c: <u>N/A</u> sq. in.		
e) Total rated area of engineered flood openings in A8.c (attach documentation – see Instructions): <u>N/A</u> sq. ft.		
f) Sum of A8.d and A8.e rated area (if applicable – see Instructions): <u>N/A</u> sq. ft.		
A9. For a building with an attached garage:		
a) Square footage of attached garage: <u>N/A</u> sq. ft.		
b) Is there at least one permanent flood opening on two different sides of the attached garage? <input type="checkbox"/> Yes <input type="checkbox"/> No <input checked="" type="checkbox"/> N/A		
c) Enter number of permanent flood openings in the attached garage within 1.0 foot above adjacent grade: Non-engineered flood openings: <u>N/A</u> Engineered flood openings: <u>N/A</u>		
d) Total net open area of non-engineered flood openings in A9.c: <u>N/A</u> sq. in.		
e) Total rated area of engineered flood openings in A9.c (attach documentation – see Instructions): <u>N/A</u> sq. ft.		
f) Sum of A9.d and A9.e rated area (if applicable – see Instructions): <u>N/A</u> sq. ft.		
SECTION B – FLOOD INSURANCE RATE MAP (FIRM) INFORMATION		
B1.a. NFIP Community Name: <u>DODDRIDGE COUNTY</u>		B1.b. NFIP Community Identification Number: <u>540024</u>
B2. County Name: <u>DODDRIDGE</u>	B3. State: <u>WV</u>	B4. Map/Panel No.: <u>0145</u> B5. Suffix: <u>C</u>
B6. FIRM Index Date: <u>10/04/2011</u>	B7. FIRM Panel Effective/Revised Date: <u>10/04/2011</u>	
B8. Flood Zone(s): <u>A</u>	B9. Base Flood Elevation(s) (BFE) (Zone AO, use Base Flood Depth): <u>892.9</u>	
B10. Indicate the source of the BFE data or Base Flood Depth entered in Item B9: <input type="checkbox"/> FIS <input type="checkbox"/> FIRM <input type="checkbox"/> Community Determined <input checked="" type="checkbox"/> Other: <u>WV FLOOD TOOL ADVISORY FLOOD HEIGHT (AFH)</u>		
B11. Indicate elevation datum used for BFE in Item B9: <input type="checkbox"/> NGVD 1929 <input checked="" type="checkbox"/> NAVD 1988 <input type="checkbox"/> Other/Source: _____		
B12. Is the building located in a Coastal Barrier Resources System (CBRS) area or Otherwise Protected Area (OPA)? <input type="checkbox"/> Yes <input checked="" type="checkbox"/> No Designation Date: _____ <input type="checkbox"/> CBRS <input type="checkbox"/> OPA		
B13. Is the building located seaward of the Limit of Moderate Wave Action (LiMWA)? <input type="checkbox"/> Yes <input checked="" type="checkbox"/> No		

ELEVATION CERTIFICATE

IMPORTANT: MUST FOLLOW THE INSTRUCTIONS ON INSTRUCTION PAGES 1-11

Building Street Address (including Apt., Unit, Suite, and/or Bldg. No.) or P.O. Route and Box No.:
1241 BUFFALO CALF ROAD

City: SALEM State: WV ZIP Code: 26426

FOR INSURANCE COMPANY USE

Policy Number: _____

Company NAIC Number: _____

SECTION C – BUILDING ELEVATION INFORMATION (SURVEY REQUIRED)

C1. Building elevations are based on: Construction Drawings* Building Under Construction* Finished Construction
*A new Elevation Certificate will be required when construction of the building is complete.

C2. Elevations – Zones A1–A30, AE, AH, AO, A (with BFE), VE, V1–V30, V (with BFE), AR, AR/A, AR/AE, AR/A1–A30, AR/AH, AR/AO, A99. Complete Items C2.a–h below according to the Building Diagram specified in Item A7. In Puerto Rico only, enter meters.
Benchmark Utilized: OPUS Vertical Datum: NAVD88

Indicate elevation datum used for the elevations in items a) through h) below.

NGVD 1929 NAVD 1988 Other: _____

Datum used for building elevations must be the same as that used for the BFE. Conversion factor used? Yes No
If Yes, describe the source of the conversion factor in the Section D Comments area.

		Check the measurement used:	
a) Top of bottom floor (including basement, crawlspace, or enclosure floor):	921.2	<input checked="" type="checkbox"/> feet	<input type="checkbox"/> meters
b) Top of the next higher floor (see Instructions):	923.3	<input checked="" type="checkbox"/> feet	<input type="checkbox"/> meters
c) Bottom of the lowest horizontal structural member (see Instructions):	N/A	<input type="checkbox"/> feet	<input type="checkbox"/> meters
d) Attached garage (top of slab):	N/A	<input type="checkbox"/> feet	<input type="checkbox"/> meters
e) Lowest elevation of Machinery and Equipment (M&E) servicing the building (describe type of M&E and location in Section D Comments area):	923.3	<input checked="" type="checkbox"/> feet	<input type="checkbox"/> meters
f) Lowest Adjacent Grade (LAG) next to building: <input checked="" type="checkbox"/> Natural <input type="checkbox"/> Finished	919.0	<input checked="" type="checkbox"/> feet	<input type="checkbox"/> meters
g) Highest Adjacent Grade (HAG) next to building: <input checked="" type="checkbox"/> Natural <input type="checkbox"/> Finished	921.2	<input checked="" type="checkbox"/> feet	<input type="checkbox"/> meters
h) Finished LAG at lowest elevation of attached deck or stairs, including structural support:	918.0	<input checked="" type="checkbox"/> feet	<input type="checkbox"/> meters

SECTION D – SURVEYOR, ENGINEER, OR ARCHITECT CERTIFICATION

This certification is to be signed and sealed by a land surveyor, engineer, or architect authorized by state law to certify elevation information. I certify that the information on this Certificate represents my best efforts to interpret the data available. I understand that any false statement may be punishable by fine or imprisonment under 18 U.S. Code, Section 1001.

Were latitude and longitude in Section A provided by a licensed land surveyor? Yes No

Check here if attachments and describe in the Comments area.

Certifier's Name: GARRETT A. DEVERICKS License Number: 2468

Title: OWNER/ PROFESSIONAL SURVEYOR

Company Name: DEVERICKS LAND SURVEYING, LLC.

Address: P.O. BOX 93

City: SALEM State: WV ZIP Code: 26426

Telephone: (304) 695-3416 Ext.: _____ Email: DEVERICKSPS2468@GMAIL.COM

Signature: Garrett A. Devericks Date: 3/16/2020

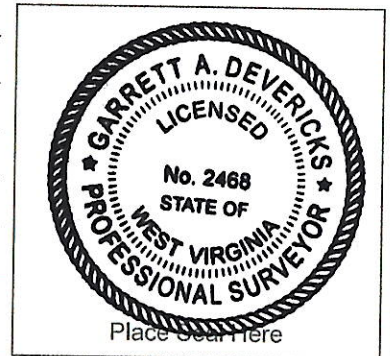

Copy all pages of this Elevation Certificate and all attachments for (1) community official, (2) insurance agent/company, and (3) building owner.

Comments (including source of conversion factor in C2; type of equipment and location per C2.e; and description of any attachments):

FEMA FIRMeTte & WV Flood Tool Map attached

OPUS report attached

House is manufactured home on block columns with "crawlspace" confined by underpinning. Wooden porches are attached on both front and back of the home.

ELEVATION CERTIFICATE

IMPORTANT: MUST FOLLOW THE INSTRUCTIONS ON INSTRUCTION PAGES 1-11

Building Street Address (including Apt., Unit, Suite, and/or Bldg. No.) or P.O. Route and Box No.:

1241 BUFFALO CALF ROAD

FOR INSURANCE COMPANY USE

Policy Number: _____

City: SALEM State: WV ZIP Code: 26426

Company NAIC Number: _____

SECTION E – BUILDING MEASUREMENT INFORMATION (SURVEY NOT REQUIRED) FOR ZONE AO, ZONE AR/AO, AND ZONE A (WITHOUT BFE)

For Zones AO, AR/AO, and A (without BFE), complete Items E1–E5. For Items E1–E4, use natural grade, if available. If the Certificate is intended to support a Letter of Map Change request, complete Sections A, B, and C. Check the measurement used. In Puerto Rico only, enter meters.

Building measurements are based on: Construction Drawings* Building Under Construction* Finished Construction

*A new Elevation Certificate will be required when construction of the building is complete.

E1. Provide measurements (C.2.a in applicable Building Diagram) for the following and check the appropriate boxes to show whether the measurement is above or below the natural HAG and the LAG.

a) Top of bottom floor (including basement, crawlspace, or enclosure) is: _____ 0.0 feet meters above or below the HAG.

b) Top of bottom floor (including basement, crawlspace, or enclosure) is: _____ 0.0 feet meters above or below the LAG.

E2. For Building Diagrams 6–9 with permanent flood openings provided in Section A Items 8 and/or 9 (see pages 1–2 of Instructions), the next higher floor (C2.b in applicable Building Diagram) of the building is: _____ 2.1 feet meters above or below the HAG.

E3. Attached garage (top of slab) is: _____ N/A feet meters above or below the HAG.

E4. Top of platform of machinery and/or equipment servicing the building is: _____ 2.1 feet meters above or below the HAG.

E5. Zone AO only: If no flood depth number is available, is the top of the bottom floor elevated in accordance with the community's floodplain management ordinance? Yes No Unknown The local official must certify this information in Section G.

SECTION F – PROPERTY OWNER (OR OWNER'S AUTHORIZED REPRESENTATIVE) CERTIFICATION

The property owner or owner's authorized representative who completes Sections A, B, and E for Zone A (without BFE) or Zone AO must sign here. *The statements in Sections A, B, and E are correct to the best of my knowledge*

Check here if attachments and describe in the Comments area.

Property Owner or Owner's Authorized Representative Name: _____

Address: _____

City: _____ State: _____ ZIP Code: _____

Telephone: _____ Ext.: _____ Email: _____

Signature: _____ Date: _____

Comments: _____

ELEVATION CERTIFICATE

IMPORTANT: MUST FOLLOW THE INSTRUCTIONS ON INSTRUCTION PAGES 1-11

Building Street Address (including Apt., Unit, Suite, and/or Bldg. No.) or P.O. Route and Box No.:
1241 BUFFALO CALF ROAD

City: SALEM State: WV ZIP Code: 26426

FOR INSURANCE COMPANY USE

Policy Number: _____

Company NAIC Number: _____

SECTION G – COMMUNITY INFORMATION (RECOMMENDED FOR COMMUNITY OFFICIAL COMPLETION)

The local official who is authorized by law or ordinance to administer the community's floodplain management ordinance can complete Section A, B, C, E, G, or H of this Elevation Certificate. Complete the applicable item(s) and sign below when:

- G1. The information in Section C was taken from other documentation that has been signed and sealed by a licensed surveyor, engineer, or architect who is authorized by state law to certify elevation information. (Indicate the source and date of the elevation data in the Comments area below.)
- G2.a. A local official completed Section E for a building located in Zone A (without a BFE), Zone AO, or Zone AR/AO, or when item E5 is completed for a building located in Zone AO.
- G2.b. A local official completed Section H for insurance purposes.
- G3. In the Comments area of Section G, the local official describes specific corrections to the information in Sections A, B, E and H.
- G4. The following information (Items G5–G11) is provided for community floodplain management purposes.
- G5. Permit Number: _____ G6. Date Permit Issued: _____
- G7. Date Certificate of Compliance/Occupancy Issued: _____
- G8. This permit has been issued for: New Construction Substantial Improvement
- G9.a. Elevation of as-built lowest floor (including basement) of the building: _____ feet meters Datum: _____
- G9.b. Elevation of bottom of as-built lowest horizontal structural member: _____ feet meters Datum: _____
- G10.a. BFE (or depth in Zone AO) of flooding at the building site: _____ feet meters Datum: _____
- G10.b. Community's minimum elevation (or depth in Zone AO) requirement for the lowest floor or lowest horizontal structural member: _____ feet meters Datum: _____
- G11. Variance issued? Yes No If yes, attach documentation and describe in the Comments area.

The local official who provides information in Section G must sign here. *I have completed the information in Section G and certify that it is correct to the best of my knowledge. If applicable, I have also provided specific corrections in the Comments area of this section.*

Local Official's Name: _____ Title: _____

NFIP Community Name: _____

Telephone: _____ Ext.: _____ Email: _____

Address: _____

City: _____ State: _____ ZIP Code: _____

Signature: _____ Date: _____

Comments (including type of equipment and location, per C2.e; description of any attachments; and corrections to specific information in Sections A, B, D, E, or H):

ELEVATION CERTIFICATE

IMPORTANT: MUST FOLLOW THE INSTRUCTIONS ON INSTRUCTION PAGES 1-11

Building Street Address (including Apt., Unit, Suite, and/or Bldg. No.) or P.O. Route and Box No.:

1241 BUFFALO CALF ROAD

FOR INSURANCE COMPANY USE

Policy Number: _____

City: SALEM State: WV ZIP Code: 26426

Company NAIC Number: _____

SECTION H – BUILDING'S FIRST FLOOR HEIGHT INFORMATION FOR ALL ZONES (SURVEY NOT REQUIRED) (FOR INSURANCE PURPOSES ONLY)

The property owner, owner's authorized representative, or local floodplain management official may complete Section H for all flood zones to determine the building's first floor height for insurance purposes. Sections A, B, and I must also be completed. Enter heights to the nearest tenth of a foot (nearest tenth of a meter in Puerto Rico). *Reference the Foundation Type Diagrams (at the end of Section H Instructions) and the appropriate Building Diagrams (at the end of Section I Instructions) to complete this section.*

H1. Provide the height of the top of the floor (as indicated in Foundation Type Diagrams) above the Lowest Adjacent Grade (LAG):

a) For Building Diagrams 1A, 1B, 3, and 5–8. Top of bottom _____ feet meters above the LAG floor (include above-grade floors only for buildings with crawlspaces or enclosure floors) is:

b) For Building Diagrams 2A, 2B, 4, and 6–9. Top of next higher floor (i.e., the floor above basement, crawlspace, or enclosure floor) is: _____ 4.3 feet meters above the LAG

H2. Is all Machinery and Equipment servicing the building (as listed in Item H2 instructions) elevated to or above the floor indicated by the H2 arrow (shown in the Foundation Type Diagrams at end of Section H instructions) for the appropriate Building Diagram?

Yes No

SECTION I – PROPERTY OWNER (OR OWNER'S AUTHORIZED REPRESENTATIVE) CERTIFICATION

The property owner or owner's authorized representative who completes Sections A, B, and H must sign here. *The statements in Sections A, B, and H are correct to the best of my knowledge.* Note: If the local floodplain management official completed Section H, they should indicate in Item G2.b and sign Section G.

Check here if attachments are provided (including required photos) and describe each attachment in the Comments area.

Property Owner or Owner's Authorized Representative Name: _____

Address: _____

City: _____ State: _____ ZIP Code: _____

Telephone: _____ Ext.: _____ Email: _____

Signature: _____ Date: _____

Comments:

Utilities Comment:

All machinery/equipment is on first floor level of home. HVAC ductwork was the only "equipment" observed under first floor

ELEVATION CERTIFICATE

IMPORTANT: MUST FOLLOW THE INSTRUCTIONS ON INSTRUCTION PAGES 1-11

BUILDING PHOTOGRAPHS

See Instructions for Item A6.

Building Street Address (including Apt., Unit, Suite, and/or Bldg. No.) or P.O. Route and Box No.:
1241 BUFFALO CALF ROAD

FOR INSURANCE COMPANY USE

City: SALEM State: WV ZIP Code: 26426

Policy Number: _____

Company NAIC Number: _____

Instructions: Insert below at least two and when possible four photographs showing each side of the building (for example, may only be able to take front and back pictures of townhouses/rowhouses). Identify all photographs with the date taken and "Front View," "Rear View," "Right Side View," or "Left Side View." Photographs must show the foundation. When flood openings are present, include at least one close-up photograph of representative flood openings or vents, as indicated in Sections A8 and A9.



Photo One

Photo One Caption: FRONT - SOUTH FACING SIDE - 2/28/2026

Clear Photo One



Photo Two

Photo Two Caption: RIGHT SIDE - EAST FACING SIDE - 2/28/2026

Clear Photo Two

ELEVATION CERTIFICATE

IMPORTANT: MUST FOLLOW THE INSTRUCTIONS ON INSTRUCTION PAGES 1-11

BUILDING PHOTOGRAPHS

Continuation Page

Building Street Address (including Apt., Unit, Suite, and/or Bldg. No.) or P.O. Route and Box No.:
1241 BUFFALO CALF ROAD

FOR INSURANCE COMPANY USE

City: SALEM State: WV ZIP Code: 26426

Policy Number: _____

Company NAIC Number: _____

Insert the third and fourth photographs below. Identify all photographs with the date taken and "Front View," "Rear View," "Right Side View," or "Left Side View." When flood openings are present, include at least one close-up photograph of representative flood openings or vents, as indicated in Sections A8 and A9.

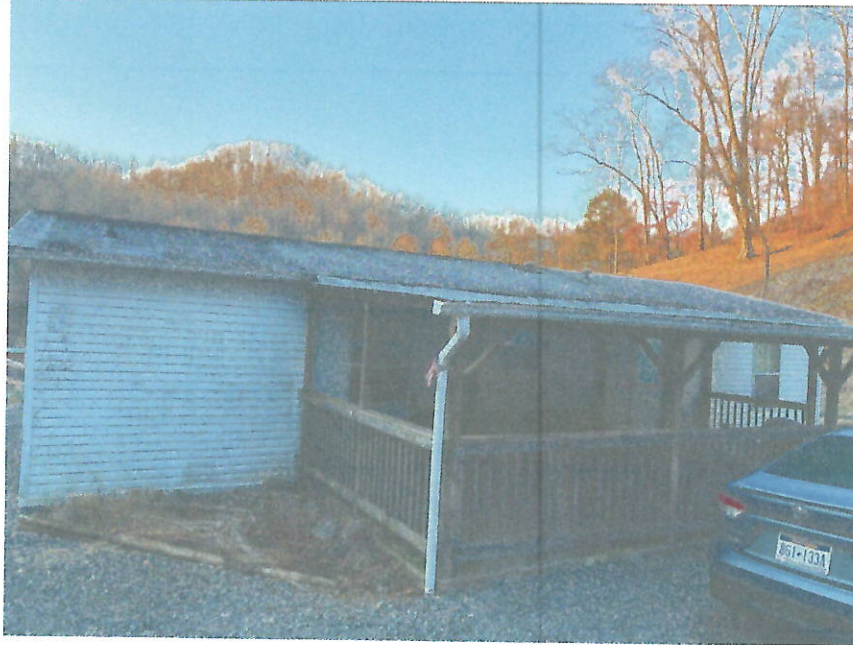

Photo Three

Photo Three Caption: REAR - NORTH FACING SIDE - 2/28/2026

Clear Photo Three



Photo Four

Photo Four Caption: LEFT SIDE - WEST FACING SIDE - 2/28/2026

Clear Photo Four

WV Flood Map



This map is not the official regulatory FIRM or DFIRM. Its purpose is to assist with determining potential flood risk for the selected location.

<p>H I G H R I S K</p> <p>Zone AE 1-Percent-Annual-Chance Flood Hazard Area With Base Flood Elevation (BFE)</p> <p>Floodway Regulatory Floodway in AE Zone</p> <p>Zone A 1-Percent-Annual-Chance Flood Hazard Area Without BFE (may have Advisory Flood Heights)</p> <p>Advisory 1-Percent-Annual-Chance High Risk Advisory</p> <p>Download the Full Legend for all flood tool symbols https://www.mapwv.gov/flood/map/docs/wv_flood_tool_legend.pdf</p> <p>Disclaimer: The online map is for use in administering the National Flood Insurance Program. It does not necessarily identify all areas subject to flooding, particularly from local drainage sources of small size. Refer to the official Flood Insurance Study (FIS) for detailed flood elevation data in flood profiles and data tables. WV Flood Tool (https://www.mapwv.gov/flood) is supported by FEMA, WV NFIP Office, and WV GIS Technical Center.</p>		<p> Flood Info Location Map created on 2/23/2026</p> <p>User Billy Davis 1241 Buffalo Calf Road</p> <p>Notes</p>	
		Flood Hazard Area	Location is WITHIN the FEMA 100-year floodplain. Advisory Flood Heights available.
		Flood Zone	A (Advisory Flood Heights available)
		Stream	Buffalo Calf Fork
		Watershed (HUC8)	Little Musringum-Middle Island (5030201)
		Flood Height	About 892.9 ft (Source: AFH) NAVD88
		Water Depth	About 0.6 ft (Source: HEC-RAS)
		Elevation	895.2 ft (Source: FEMA 2018-20) (NAVD88)
		Community & ID	Doddridge County (ID: 540024)
		FEMA Map & Date	54017C0145C; Effective Date: 10/4/2011
		Location (lat, long)	(39.257829, -80.626754) (WGS84)
		Parcel ID	No Parcel
		E-911 Address	

National Flood Hazard Layer FIRMette

80°37'56"W 39°15'45"N



Legend

SEE FIS REPORT FOR DETAILED LEGEND AND INDEX MAP FOR FIRM PANEL LAYOUT

SPECIAL FLOOD HAZARD AREAS

- Without Base Flood Elevation (BFE)
Zone A, V, AG9
- With BFE or Depth *Zone AE, AO, AH, VE, AR*
- Regulatory Floodway

OTHER AREAS OF FLOOD HAZARD

- 0.2% Annual Chance Flood Hazard, Areas of 1% annual chance flood with average depth less than one foot or with drainage areas of less than one square mile *Zone X*
- Future Conditions 1% Annual Chance Flood Hazard *Zone X*
- Area with Reduced Flood Risk due to Levee. See Notes, *Zone X*
- Area with Flood Risk due to Levee *Zone D*

OTHER AREAS

- Area of Minimal Flood Hazard *Zone X*
- Effective LOMRs
- Area of Undetermined Flood Hazard *Zone I*

GENERAL STRUCTURES

- Channel, Culvert, or Storm Sewer
- Levee, Dike, or Floodwall

OTHER FEATURES

- Cross Sections with 1% Annual Chance Water Surface Elevation
- Coastal Transect
- Base Flood Elevation Line (BFE)
- Limit of Study
- Jurisdiction Boundary
- Coastal Transect Baseline
- Profile Baseline
- Hydrographic Feature

MAP PANELS

- Digital Data Available
- No Digital Data Available
- Unmapped

The pin displayed on the map is an approximate point selected by the user and does not represent an authoritative property location.

This map complies with FEMA's standards for the use of digital flood maps if it is not void as described below. The basemap shown complies with FEMA's basemap accuracy standards.

The flood hazard information is derived directly from the authoritative NFHL web services provided by FEMA. This map was exported on **2/23/2026 at 8:19 PM** and does not reflect changes or amendments subsequent to this date and time. The NFHL and effective information may change or become superseded by new data over time.

This map image is void if the one or more of the following map elements do not appear: basemap imagery, flood zone labels, legend, scale bar, map creation date, community identifiers, FIRM panel number, and FIRM effective date. Map images for unmapped and unmodernized areas cannot be used for regulatory purposes.





Garrett Devericks <garrett@triplehenterprises.net>

OPUS-RS solution : 1 TR503522317823

1 message

opus <opus@ngs.noaa.gov>
 Reply-To: ngs.opus@noaa.gov
 To: garrett@triplehenterprises.net

Mon, Mar 2, 2026 at 7:14 AM

FILE: 1 TR503522317823

NGS OPUS-RS SOLUTION REPORT

=====

All computed coordinate accuracies are listed as 1-sigma RMS values.
 For additional information: <https://www.ngs.noaa.gov/OPUS/about.jsp#accuracy>

USER: garrett@triplehenterprises.net DATE: March 02, 2026
 RINEX FILE: 1__059m.26o TIME: 12:13:29 UTC

SOFTWARE: rsgps 1.38 RS252.prl 1.99.3 START: 2026/02/28 12:55:00
 EPHEMERIS: igu24076.eph [ultra-rapid] STOP: 2026/02/28 14:45:00
 NAV FILE: brdc0590.26n OBS USED: 9972 / 10863 : 92%
 ANT NAME: TRMR8_GNSS NONE QUALITY IND. 37.80/ 68.51
 ARP HEIGHT: 1.9971 NORMALIZED RMS: 0.346

REF FRAME: NAD_83(2011)(EPOCH:2010.0000) ITRF2020 (EPOCH:2026.16048)

X:	805448.076(m)	0.009(m)	805447.083(m)	0.009(m)
Y:	-4879416.455(m)	0.019(m)	-4879415.031(m)	0.019(m)
Z:	4014676.750(m)	0.016(m)	4014676.690(m)	0.016(m)

LAT:	39 15 28.32224	0.005(m)	39 15 28.35288	0.005(m)
E LON:	279 22 23.95736	0.009(m)	279 22 23.92615	0.009(m)
W LON:	80 37 36.04264	0.009(m)	80 37 36.07385	0.009(m)
EL HGT:	240.657(m)	0.024(m)	239.406(m)	0.024(m)
ORTHO HGT:	273.576(m)	0.032(m)	[NAVD88 (Computed using GEOID18)]	

UTM COORDINATES STATE PLANE COORDINATES

	UTM (Zone 17)	SPC (4701 WV N)
Northing (Y) [meters]	4345459.431	84745.728
Easting (X) [meters]	532208.942	502761.466
Convergence [degrees]	0.23624444	-0.71856389
Point Scale	0.99961277	0.99996126
Combined Factor	0.99957503	0.99992351

US NATIONAL GRID DESIGNATOR: 17SND3220845459(NAD 83)

BASE STATIONS USED

PID	DESIGNATION	LATITUDE	LONGITUDE	DISTANCE(m)
DN9087	WVTA TERRA ALTA CORS ARP	N392616.643	W0793052.953	97922.4
DM4710	WVNR ELKINS CORS ARP	N385344.505	W0795130.270	77698.3
DM2710	WVMZ MOUNT ZION CORS ARP	N385020.043	W0810631.582	62492.8
DR6963	OHME OHME MONROE CNTY2 CORS GRP	N394638.547	W0810606.947	70691.9
DK6718	PAFU UNIONTOWN CORS ARP	N395535.688	W0794150.510	109019.7
DM4706	WVCV CANAAN VALLEY CORS ARP	N390055.076	W0792725.009	104668.9
DH9003	WVRA MARSHALL UNIV-RAV CORS ARP	N385628.863	W0814504.842	103441.5
DM4001	WVSH SHERRARD CORS ARP	N395949.099	W0804046.361	82190.0

DL7341 WVBU BURLINGTON WV CORS ARP N392016.821 W0785448.587 148049.5

NEAREST NGS PUBLISHED CONTROL POINT

JX0251 T 80 N391629.000 W0803733.000 1872.7

This position and the above vector components were computed without any knowledge by the National Geodetic Survey regarding the equipment or field operating procedures used.

 **1_059m.26o.xml**
6K